

Truck / CV Special 2023



Das Werkzeug

Our superheroes ...



... whether truck, trailer, bus, construction machine or agricultural!

We are commercial vehicles!

€ NKW23/EN/XX/1

Recommended retail prices (RRPs) excl. VAT.
Prices valid from 1 March 2023 until 29 February 2024
at the latest. Prices are subject to change before
29 February 2024. Errors excepted.

Cooling system diagnostics

- » Precise checking for leakage in cooling systems and heating circuits
- » Reliable diagnosis thanks to precisely matched threads on the expansion tank opening
- » Extensive adapter family "Made in Germany"
- » Bubble-free filling of the cooling and heating circuit with 4802-1 in trucks, buses, agricultural machinery and construction vehicles

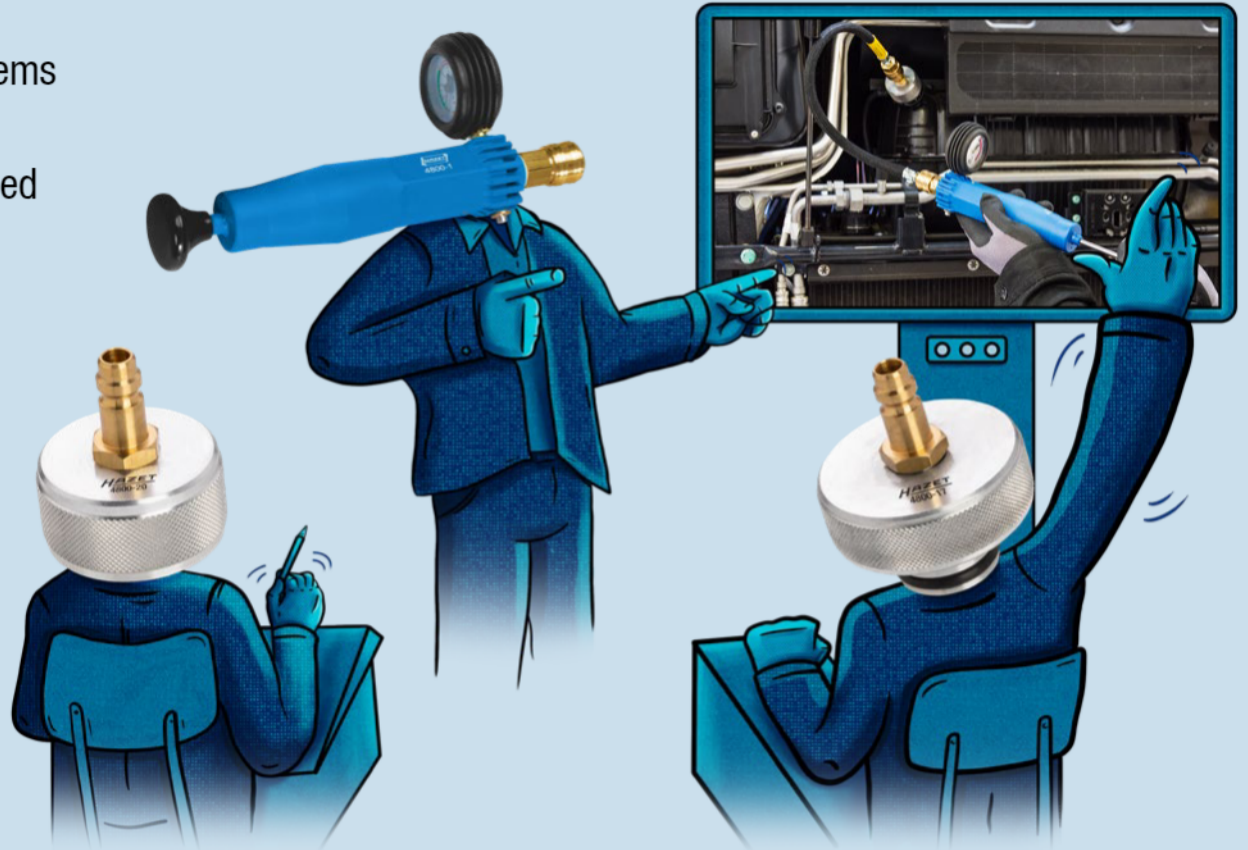

4802-1, EAN-No. 4000896200030

Commercial vehicle vacuum radiator filler

- Fast cooling fluid flow rate: approx. 80 l in approx. 20 minutes
- No cooling fluid is lost through the cooling system overflowing
- Separate control through the diagnostic testing device is no longer necessary
- Vacuum leakage test before filling the cooling system
- Bubble-free filling of the cooling and heating circuit in trucks, buses, agricultural machinery and construction vehicles
- Can be used together with single or universal adapters (see table on page 3)



80 litres in 20 minutes!

Made in Germany

326.- € net



4800/8, EAN-No. 4000896216499

Radiator adapter case for commercial vehicles

- Checking for leakage in cooling systems and heating circuits
- 4800-1 Cooling pump to 2.5 bar
- 4800-2 Intermediary piece, flexible hose
- 4800-3 Radiator adapter for DAF 45 model year 05/1991 → 12/2000, DOOSAN Wheel excavator S, Caterpillar excavator DX, KAESER Mobilair, LIEBHERR A308-316, MERCEDES-BENZ Vito, Viano, Solaris, NISSAN forklifts, PUTZMEISTER BSA 1409, SCANIA Vabis
- 4800-5 A Radiator adapter for COMPAIR mobile compressor with VW expansion tank, LINDE forklifts, PUTZMEISTER BSA 1407D · BSA 2110 HP-D, RENAULT Midium model year 01/2000 → 12/2013, Volvo FE model year 05/2006 → FL model year 03/2000 →
- 4800-25 radiator adapter for MAN buses such as Lions Coach, Lions Star, Lions Comfort, Lions City, MERCEDES-BENZ Citaro model year 01/1998, IVECO Euro-Star, Euro-Tech, Euro-Truck, Stralis, Daily, with black lock, MAN F90, F2000, TGA model year 03/2000 → TGL model year 04/2005 → TGM model year 10/2005 → TGS model year 10/2007 → 01/2012, TGX model year 10/2007 → 01/2012, MERCEDES-BENZ commercial vehicles Actros, Atego 1217 model year → 1999, Eco 8401, SK1728 Antos, Arocs, Atego model year 1998 → 2013, Axor model year 09/2001 → 10/2004, Eonic, Zentros
- 4800-26 Radiator adapter for DAF CF, XF Euro 6 model year 2013 →
- 4800-27 Radiator adapter for MERCEDES-BENZ Atego model year 2014 →
- 4800-28 Radiator adapter for MERCEDES-BENZ Actros EURO 6 with HEYCO expansion tank model year 2014 → MAN TGX, TGS EURO 6 with HEYCO expansion tank model year 2012 →
- Classification to vehicle types: www.hazet.de → Service → The Tool Finder → Radiator adapters 4800



Made in Germany

570.40 € net



4800
Cooling pump and adapter

Made in Germany

| HAZET No. | Components | EAN-No. 4000896 + | € net |
|-----------|---|-------------------|--------|
| 4800-1 | • Cooling pump • Up to 2.5 bar | 022243 | 103.30 |
| 4800-2 | • Intermediary piece, flexible hose | 022274 | 29.30 |
| 4800-3 | <ul style="list-style-type: none"> • AMAZONE Pantera • CLAAS Jaguar, Lexion, Scorpion, Ares, Atlas, Ceres • DAF 45 model year 05/1991 → 12/2000 • DOOSAN Wheel excavator S · Caterpillar excavator DX • FENDT • KAESER Mobilair • LIEBHERR A308-316 • MASSEY FERGUSON with tank no. 180224M92 and 4296015M1 • MERCEDES-BENZ Vito · Viano · Solaris • NISSAN forklifts • PUTZMEISTER BSA 1409 • SCANIA Vabis • CASE Quadtrac, Magnum | 022281 | 23.90 |
| 4800-4A | <ul style="list-style-type: none"> • DEUTZ Engines 3.6 PowerPack · BF6M1013FC · TCD2013L6 2V and 4V Genset 250kV • HATZ 4H50tic • IVECO Eco Daily with blue lock • CASE Puma, SBS, LBS, Optum, Maxxum, CVX • NEW HOLLAND TTV, T7, T7 Elite Pack, T6 • FENDT Vario model year 2000 → Combine harvesters L series • CLAAS Arion, Axion | 156504 | 35.20 |
| 4800-5A | <ul style="list-style-type: none"> • COMPAIR Mobile compressor with VW expansion tank • FENDT Farmer 300 model year 1988 → · Type 500 · Type 700 · Vario model year 1988 → 2000 • LINDE forklifts • PUTZMEISTER BSA 1407D · BSA 2110 HP-D • RENAULT Midium model year 01/2000 → 12/2013 • Volvo FE model year 05/2006 → · FL model year 03/2000 → | 161843 | 41.- |
| 4800-16 | <ul style="list-style-type: none"> • DEUTZ Engines KHD1015 · D2008 · D2009 · TD2.9 L4 · TCD3.6 · BFM1013 · BFM2012 · TCD2013 2V · BFM1015 · TCD2015 V8 · V6 · M · TCD 12.0 and 16.0 • MERCEDES-BENZ Sprinter model year 1999 → Type 170 · 208 · 611 | 098507 | 34.50 |

| HAZET No. | Components | EAN-No. 4000896 + | € net |
|-----------|--|-------------------|-------|
| 4800-17 | <ul style="list-style-type: none"> • JOHN DEERE Tractors series 5, 6, 7, 8 and 9 · Forage harvesters series 8000 and 9000 · Self-propelled sprayer R4040, R4050, R4140 and 4150 · Windrower W170 · Cotton picker CP690 · Excavator 160DLC · Crawler dozer 700J · WHEEL LOADERS WL53, WL56 • HITACHI excavator ZAXIS 6 • HAGIE STS 10, 12, 14 and 16 | 109661 | 70.10 |
| 4800-18 | <ul style="list-style-type: none"> • MERCEDES-BENZ Sprinter since 2006, Viano since 2003 | 128815 | 77.20 |
| 4800-20 | <ul style="list-style-type: none"> • IVECO Euro-Star · Euro-Tech · Euro-Truck · Daily with black lock • MAN F90 · F2000 · TGA model year 03/2000 → · TGL model year 04/2005 → · TGM model year 10/2005 → · TGS model year 10/2007 → 01/2012 · TGX model year 10/2007 → 01/2012 • MERCEDES BENZ commercial vehicles Actros · Atego 1217 model year → 1999 · Eco 8401 · SK1728 · Antos · Arocs · Atego model year 1998 → 2013 · Axor model year 09/2001 → 10/2004 · Econic · Zetros • CLAAS Xerion, Tucano | 144242 | 54.80 |
| 4800-21A | <ul style="list-style-type: none"> • Volvo commercial vehicles • Scraper tractor dumpers | 162185 | 98.10 |
| 4800-23 | <ul style="list-style-type: none"> • ISUZU trucks • MITSUBISHI commercial vehicle Fuso Canter • NISSAN forklifts • YALE GDP/GLP 16-30 | 144273 | 63.50 |
| 4800-25 | <ul style="list-style-type: none"> • MAN buses such as Lions Coach · Lions Star · Lions Comfort · Lions City • MERCEDES-BENZ Citaro model year 01/1998 | 203857 | 73.70 |
| 4800-26 | <ul style="list-style-type: none"> • DAF CF and XF Euro 6 from 2013 | 214495 | 77.90 |
| 4800-27 | <ul style="list-style-type: none"> • MERCEDES-BENZ Atego from model year 2014 | 214501 | 91.10 |
| 4800-28 | <ul style="list-style-type: none"> • MERCEDES-BENZ Actros EURO 6 with HEYCO equalising tank from model year 2014 | 214518 | 91.10 |
| 4800-29 | <ul style="list-style-type: none"> • SCANIA 143, G-/P- and R series | 222780 | 85.10 |



4501-2, EAN-No. 4000896203499
Fuel and AdBlue® line pliers

- Simple operation of quick-release fasteners on fuel lines
- **Volvo** D13 · D16 · **MAN** D3876 LF · D1556 LF · D2676 LF and **SCANIA** engines
- **CLAAS** agricultural machinery with **MAN** engine
- **AdBlue®** lines and **AdBlue®** injection nozzles on agricultural machinery



Problem solver!

Made in Germany
47.70 € net

Commercial vehicle lifting aid

- » Back-friendly and safe work when servicing brakes
- » For working in areas with restricted access, e.g. in commercial vehicle wheel arches
- » Facilitates removal/installation of brake callipers and wheel hubs, no second person necessary any more
- » "Made in Germany"

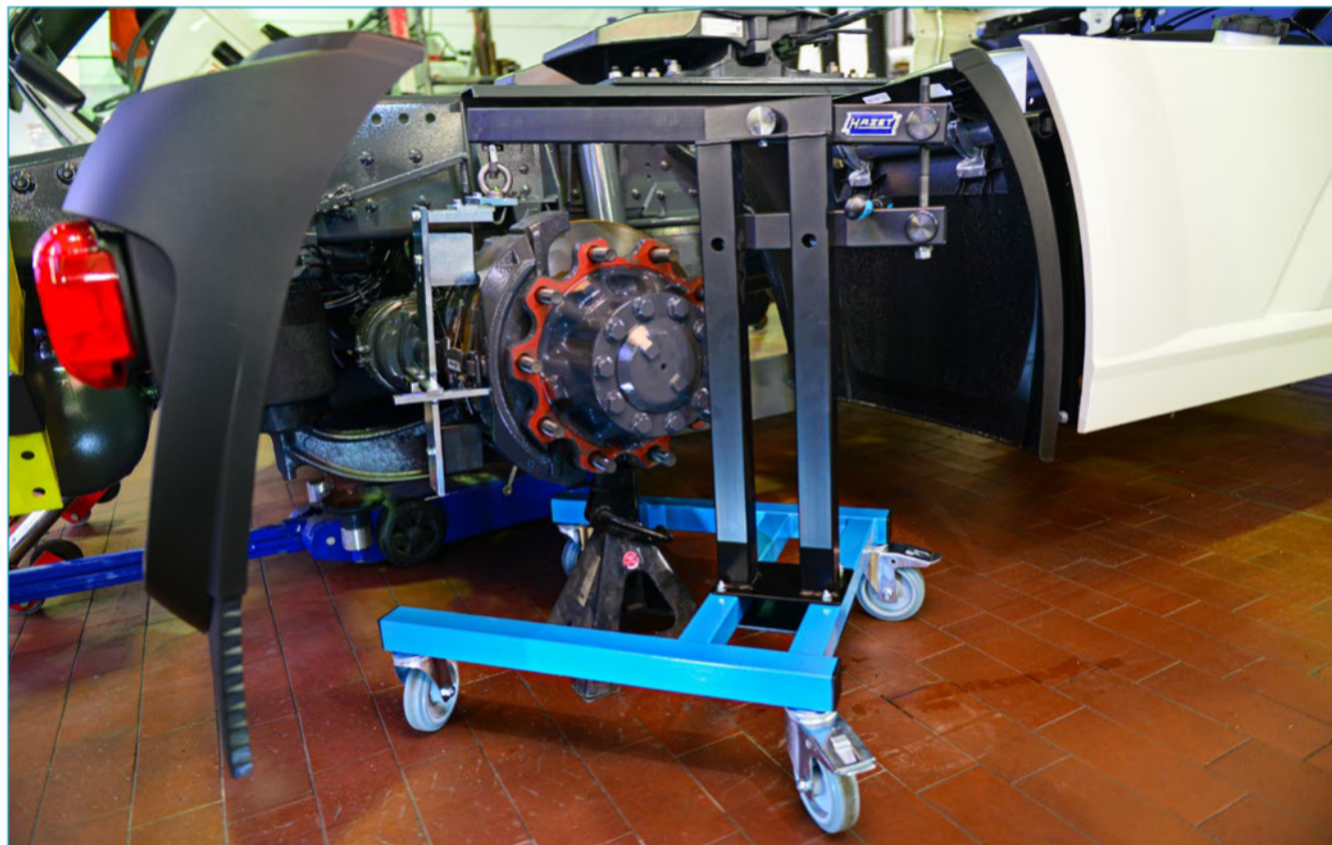
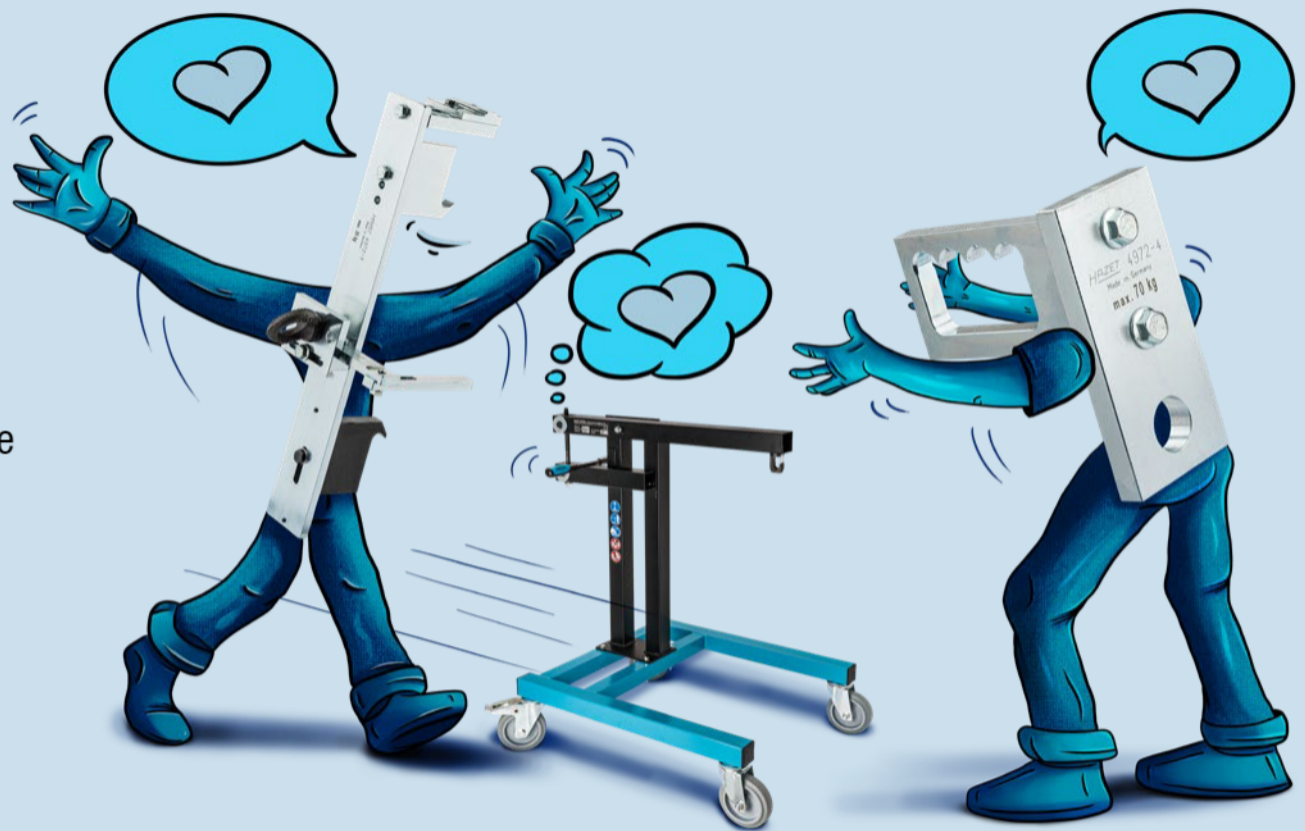

• Suitable for all brake callipers and wheel hubs

• Brake calliper removal and installation with just one tool

• All brake service work can be carried out without straining your back

• Compatible with all brake callipers that have European type approval



4972-1/3, EAN-No. 4000896215799

Commercial vehicle lifting aid

- Allows you to work safely, without straining your back, in tight spaces in the wheel arch on trucks, buses, trailers and trailer axles
- Significantly easier work when assembling and disassembling brake callipers and wheel hubs thanks to lifting aid
- No strain on the back
- Second person not required
- Makes screw tightening easier
- Secure hold for heavy components
- Takes the various installation situations of the brake calliper into consideration
- Secure movement with suspended components
- One-hand operation possible via spindle

- Contents:**
- Lifting aid
 - Brake calliper holder
 - Wheel hub holder

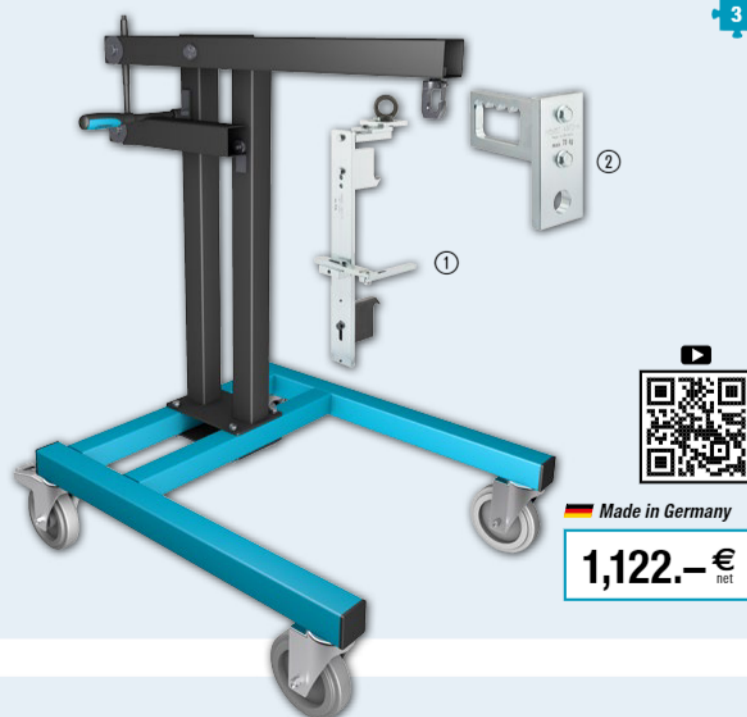

Made in Germany

1,122.- € net

Accessories

| No. | HAZET No. | Designation | Function | EAN-No. 4000896+ | € net |
|-----|-----------|--|---|------------------|-------|
| ① | 4972-1 | Commercial vehicle brake calliper holder | Use with lifting aid 4972-3 or 4972-1/3 | 215423 | 339.- |
| ② | 4972-4 | Wheel hub holder | Use with lifting aid 4972-1/3 | 216031 | 89.- |

4972-2, EAN-No. 4000896215393

Swivel bearing

- For disassembly and assembly of brake calliper in trucks, buses, trailers and trailer axles that are installed in a diagonal "clockwise position between 8 o'clock and 5 o'clock"
- Connect swivel bearing to brake calliper holder and position with e.g. jacking carriage below brake calliper. This enables easy insertion of the screws even in awkward positions
- Together with brake calliper holder HAZET 4972-1

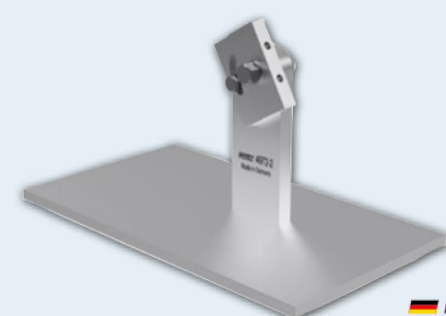

Made in Germany

157.90 € net



4971-12, EAN-No. 4000896232857

Brake resetting tool

- Resetting **WABCO** brake callipers without removing the brake cylinder
- Good accessibility of the resetting device
- Easy operation with the 3-component HAZET handle
- Operation with tried and tested HAZET ratchet wrench
- Special insert in the ratchet wrench ensures safe power transmission on the resetting device
- For **WABCO** brake calliper in **MERCEDES-BENZ** Actros, Antos, Arocs
- Length (total): 454.4 mm
- Adapter \leq 8 mm
- Ratchet wrench 10 mm



Made in Germany

67.- €
net

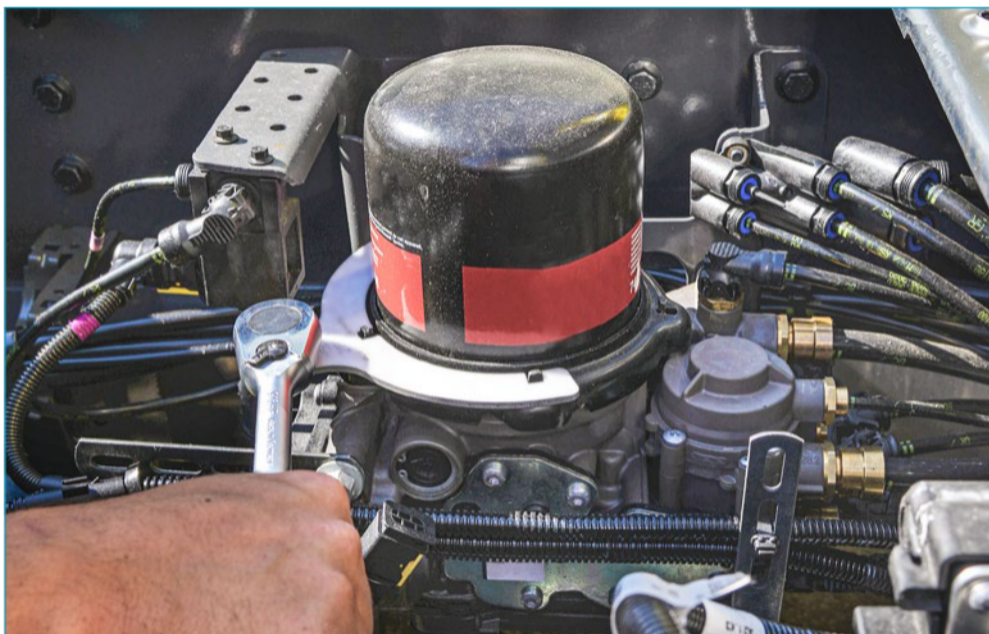

2195-1, EAN-No. 4000896228898

1/2" cartridge wrench

- Granulates cartridge with retaining ring is installed on **KNORR-BREMSE** air dryers with electronic parking brake (EPB) in **RENAULT** Trucks series T and C as well as in **Volvo** FH
- Torque-controlled tightening via integrated square 12.5 mm (1/2") possible with e.g. HAZET torque wrench 5120-3CT
- Operation of the granulates cartridge with retaining ring

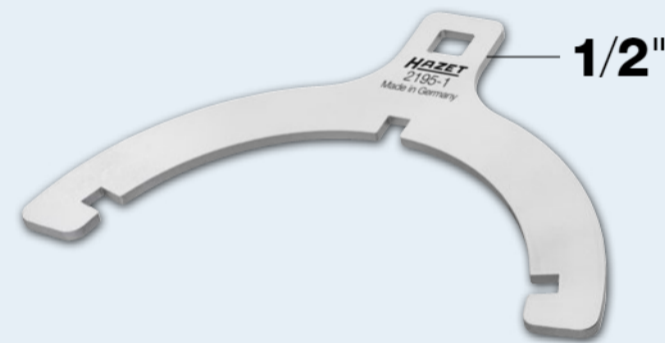

Made in Germany

18.- €
net



2872-E18 · 2872-E20 · 2872-E24

3/4" TORX® slogging wrench with 2 striking faces

- For loosening and tightening **TORX®** screws on brake calliper fittings on the front axle and trailing axles of trucks
- Use of the wrench for assembly and disassembly of the brake calliper fittings renders the disassembly of the steering tie lever unnecessary
- Correct tightening of screws with torque wrench using a 20 mm (3/4") drive in accordance with the manufacturer's specifications
- For e.g. **MAN** TGL TGM wrench sizes: E18, E20, E24
- 2872-E20 e.g. on **Schmitz** Cargobull Trailer axles

Made in Germany

| HAZET No. | Drive | Length mm | Weight g | Effective length mm | Head width mm | Head thickness mm | EAN-No. 4000896 + | € net |
|-----------|-------|-----------|----------|---------------------|---------------|-------------------|-------------------|-------|
| 2872-E18 | E18 | 215 | 573 | 120 | 30 | 12 | 201235 | 53.- |
| 2872-E20 | E20 | 216 | 577 | 120 | 32 | 12 | 201242 | 53.90 |
| 2872-E24 | E24 | 219 | 588 | 120 | 38 | 12 | 201259 | 54.- |



Wrench flat with laser-engraved formula for calculating the correct effective length!

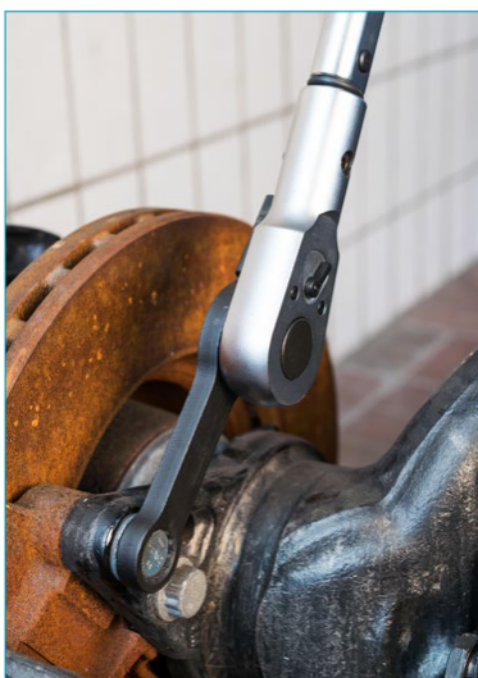

2872SZ-24 · 2872SZ-26 · 2872SZ-27 · 2872SZ-30

3/4" Commercial vehicle box-end wrench (12-point) with 2 striking faces

- 12-point profile facilitates application even on hard-to-reach fittings
- For e.g. **SAF**-brake calliper on **MERCEDES-BENZ** Atego and Actros
- Wrench with 20 mm (3/4") 4-point insertion hole for the correct tightening of screws with HAZET torque wrench in accordance with the manufacturer's specifications
- Wrench flat with laser-engraved formula for calculating the correct effective length

Made in Germany

| HAZET No. | For operation of the brake calliper screw connection on e.g. | Drive mm | Length mm | EAN-No. 4000896 + | € net |
|-----------|---|-----------|-----------|-------------------|-------|
| 2872SZ-24 | SAF -brake calliper, MERCEDES-BENZ Atego and Actros | \leq 24 | 219.0 | 204175 | 57.90 |
| 2872SZ-26 | DAF XF95/XF105/XF | \leq 26 | 219.0 | 203727 | 48.80 |
| 2872SZ-27 | MERCEDES-BENZ Atego, Actros, KÄSSBOHRER buses | \leq 27 | 220.5 | 207183 | 47.30 |
| 2872SZ-30 | SCANIA series 3, 4, G, P, T, R, S and bus | \leq 30 | 225.5 | 246281 | 44.- |



NEW!

With 3/4" drive for torque wrenches!



2784-T60/4, EAN-No. 4000896188611



3/4" screwdriver socket set for brake discs

- For impact operation
- For the operation of the brake disc screw connections on **MERCEDES-BENZ Actros**
- Length (total): 154.5 mm

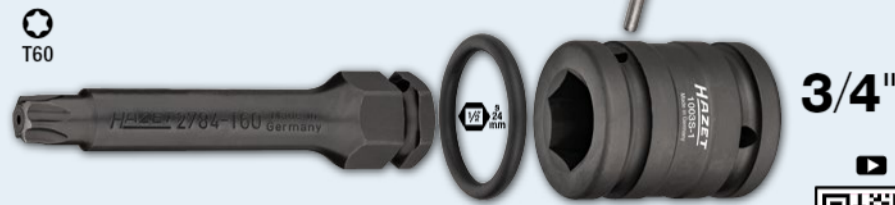

Spare blade
2784-T60

O-ring
1000S-G1736

Impact adapter
1003S-1

Connecting pin
1000S-H1736

3/4"



Made in Germany

66.30 € net

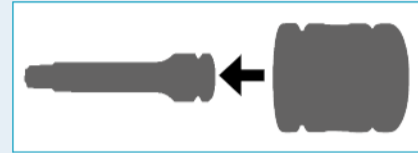

985S-14LG/4, EAN-No. 4000896243686



Brake calliper screwdriver socket

- For the operation of the brake calliper screw connections (**KNORR-BREMSE**) on **MERCEDES-BENZ** trucks e.g. Actros, Arocs, Antos and buses such as e.g. Citaro, CapaCity Turismo, Intouro and Travego
- Operation of gearbox screw connections as well as screw connections is possible on frame and chassis
- Impact wrench operation is possible with e.g. HAZET 9013TT
- Length (total) 109 mm



≤ 14 mm

Impact screwdriver socket
985S-14Lg

O-ring
1000S-G1736

Impact adapter
1003S-1

Connecting pin
1000S-H1736

3/4"



Made in Germany

40.20 € net

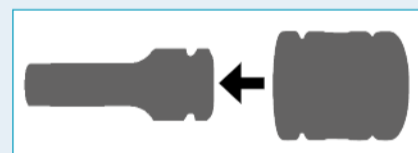

4971-11, EAN-No. 4000896218257



Brake calliper resetting tool KNORR-BREMSE

- For operation of the readjusting tool on disc brakes **KNORR-BREMSE**
- For readjusting the brake calliper **KNORR-BREMSE** via nut-driver
- **Special 11 tooth profile**
- Suitable for brake callipers **KNORR-BREMSE** on trucks, buses, trailers and trailer axles of all brands



Made in Germany

6.60 € net

2872FS-24, EAN-No. 4000896209989

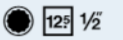

1/2" Commercial vehicle box-end wrench (12-point) with 2 striking faces

- **No need to remove the wheel, even if brake cylinder fittings protrude far into the rim**
- Use in trucks, buses, trailers and trailer axles without removing the wheel
- **For loosening or tightening brake cylinder fittings**
- Laser-engraved formula for rapid conversion of the tightening torque specified by the manufacturer
- 2 impact areas enable the force to be applied using a hammer
- Time saving (approx.): 20 min

Brake cylinder disassembly without removing the wheel!

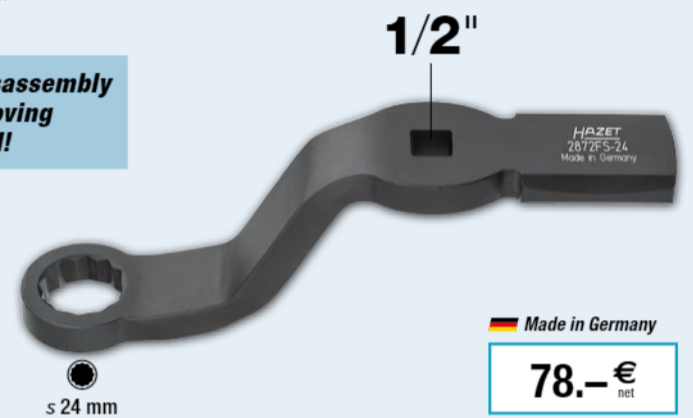

Made in Germany

78.- € net



2784-14, EAN-No. 4000896155583

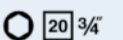

3/4" brake calliper screwdriver socket

- For the operation of the brake calliper screw connections (**KNORR-BREMSE**) on **MERCEDES-BENZ** trucks e.g. Actros

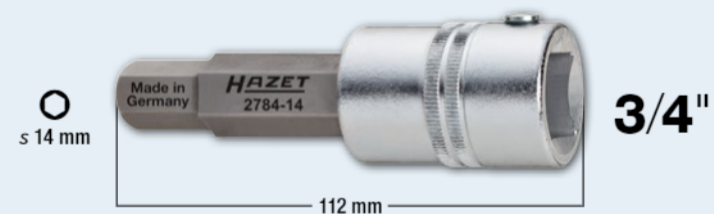

≤ 14 mm

3/4"

Made in Germany

30.80 € net

4969-612, EAN-No. 4000896204281



Compressed air quick-connector releasing tool

- **Easy loosening of quick-connectors with Ø 6, 8, 10, 12 mm**
- For operation with open-end wrench s 13 mm (HAZET 600N-13), no further tools necessary
- For plug connectors DIN 74324 6 x 1.0 · 8 x 1.0 · 10 x 1.0 · 12 x 1.5 · 12 x 2.0 mm
- Enables separating contaminated tubes and plug connectors
- To be used by one person
- Time saving and therefore also cost saving
- Prevention of injuries



≤ 13 mm



Made in Germany

55.40 € net



2195, EAN-No. 4000896014101

12 1/2

1/2" cartridge wrench

- For loosening the granulates cartridges
- Forged design
- MAN No. 8099606-0307



Made in Germany

144.70 € net



2169-32, EAN-No. 4000896082346

10 3/8

**3/8" AdBlue® filter wrench
MAN**

- For installing and removing oil filters and oil filter housing caps when changing the oil filter element
- Forged design
- For urea solution filter Ad-Blue® MAN e.g. TGX



Safe loosening and tightening of oil filter and AdBlue® covers!

Made in Germany

24.- € net

2168-46, EAN-No. 4000896156252

10 3/8

**3/8" AdBlue® filter wrench
MERCEDES-BENZ**

- For operation of the filter housing cap when replacing the filter element for AdBlue® filters (urea solution filter element) on MERCEDES-BENZ commercial vehicles with BlueTec® engines e.g. Actros, Atego, Axor, Eonic
- The tightening torque recommended by the vehicle manufacturer (please follow the instructions of the manufacturer) is reached e.g. with the torque wrench HAZET 5110-3CT
- Forged design



Made in Germany

27.50 € net

2169-36, EAN-No. 4000896086566

10 3/8

3/8" oil filter wrench

- For MERCEDES-BENZ vans, Actros MP 1, MP 2
- For MAN fuel filters, e.g. TGA
- Forged design
- Surface: chrome-plated



Made in Germany

26.50 € net

2169-9, EAN-No. 4000896116690

12 1/2 24

**1/2" commercial vehicle
oil filter wrench**

- For the operation of oil filters e.g. from MANN and MAHLE/KNECHT
- For e.g.: Volvo, SCANIA, RENAULT, MAN, IVECO, FIAT, FODEN, IRISBUS, ASTRA, CATERPILLAR, LIEBHERR, JOHN DEERE, KOMATSU, FAUN, MITSUBISHI
- The torque value recommended by the vehicle manufacturer can be safely achieved, e.g. with a HAZET torque wrench (Attention: observe the manufacturer's tightening torque value)



Made in Germany

18.70 € net

For over
1600
applications!

2171-1 · 2171-2

12 1/2

1/2" oil filter wrench

- Steel strip adjustable to seven positions
- Operation of oil filters e.g. as an assembly tool for oil and fuel filters on MAN commercial vehicles



Made in Germany

| No. | HAZET No. | Length mm | Ø mm | EAN-No. 4000896+ | € net |
|-----|-----------|-----------|--------|------------------|-------|
| ① | 2171-1 | 160 | 80-110 | 013418 | 39.- |
| ② | 2171-2 | 220 | 75-110 | 013432 | 45.- |



4797-5, EAN-No. 4000896176137

Injector extractor

- For disassembly of tight common rail injectors without removing the cylinder head
- For the simple removal of injectors together with sliding hammer, e.g. HAZET 1788T-1, on **MAN** engines D08, D20, D26 and D28
- Especially suited to the very limited space in the cylinder head
- Due to the tool's special claw, the injector may be gripped with caution, damage-free removal with the aid of the impact extractor
- Injector claw with inside thread M10 x 1.5 mm for insertion of the sliding hammer 1788T-1

Made in Germany

163.70 € net

Can only be used in combination with 1788T-1!

1788T-1, EAN-No. 4000896134304

Sliding hammer

- With coupler thread M 10 (sliding weight 200 g)
- Together with injector extractor 4797-5
- Coupler thread M10
- Incl. union nut

Made in Germany

27.50 € net

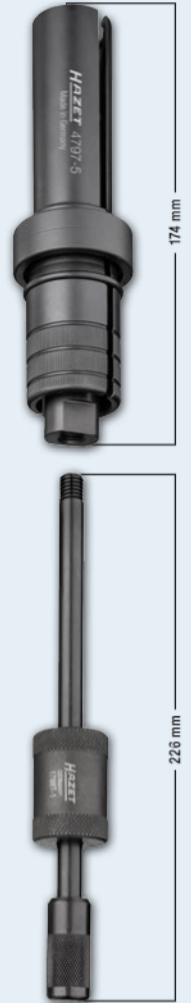

4550-21, EAN-No. 4000896204137

1/2" injection line wrench DAF

- The special design of the socket ensures proper seat of the injection line fitting
- For the operation of the union nut on the high-pressure line on the injection valve-common rail injection system
- Open double hexagon socket for injection lines
- The tightening torque required by the manufacturer is achieved by using a torque wrench, for example, the HAZET 5120-3CT (observe manufacturer specifications)
- **DAF** Euro 6 engines MX11/MX13 e.g. XF, CF
- Surface: burnished

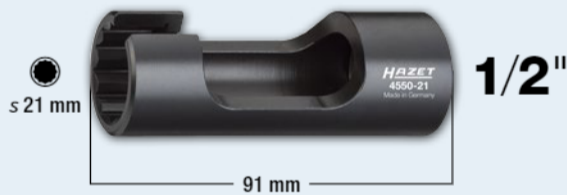

Made in Germany

28.50 € net

2850-E20 · 2850-E24

3/4" TORX® impact socket

- **For the operation of cylinder head bolts**
- Long, reinforced design
- With borehole for locking pin or safety spring and groove for o-ring
- Surface: phosphatized, oiled

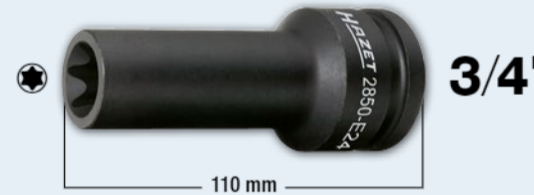
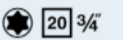

Made in Germany

| HAZET No. | mm | EAN-No. 4000896+ | € net |
|-----------|-------|------------------|-------|
| 2850-E20 | 18.49 | 079681 | 34.60 |
| 2850-E24 | 22.16 | 146758 | 38.90 |

4550N-22, EAN-No. 4000896234387

1/2" injection line wrench MAN

- The special design of the socket ensures proper seat of the injection line fitting
- Open double hexagon socket for injection lines
- The tightening torque required by the manufacturer is achieved by using a torque wrench, for example, the HAZET 5120-3CT (observe manufacturer specifications)
- Output: outside double hexagon profile s 22 mm
- Surface: burnished



Made in Germany

25.- € net

4550-3, EAN-No. 4000896104307

3/8" injection line wrench

- Open double hexagon socket for injection lines
- For the operation of screwed connections on injection lines of **MAN** trucks with D 20 engines – Common rail injection systems
- Surface: chrome-plated

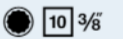

Made in Germany

59.- € net

4558, EAN-No. 4000896021888

1/2" pressure nut crown wrench

- For the operation of the compression nut at the nozzle holder
- For **MAN** and **MERCEDES-BENZ** trucks M 401/421, M 402/422, LA, A, M 403/423, M 470h
- Surface: chrome-plated



Made in Germany

41.90 € net

4550-2, EAN-No. 4000896021734

1/2" injection line wrench

- Open double hexagon socket
- For the operation of screwed connections on injection lines e.g. for **MERCEDES-BENZ**
- Surface: chrome-plated

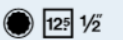

Made in Germany

54.80 € net

Axle repair precision tools

- » Much greater ease for axle repairs and maintenance work
- » For trouble-free removal/installation work on many commercial vehicles
- » High fitting accuracy and perfect seating
- » Robust HAZET quality "Made in Germany"*



*except 772-2/16



772-2/16, EAN-No. 4000896161041

20 3/4 16

3/4" universal tool set for axle and slotted nut wrench set

- For removal and precise installation, e.g. with 6-point and 8-point nuts, slotted nuts, face nuts, round nuts with drilled holes, round nuts with pin holes, etc.
- Clamping range: 35–170 mm
- Torque (max.): 700 Nm
- 16-pieces in HAZET Safety-Insert-System soft foam insert

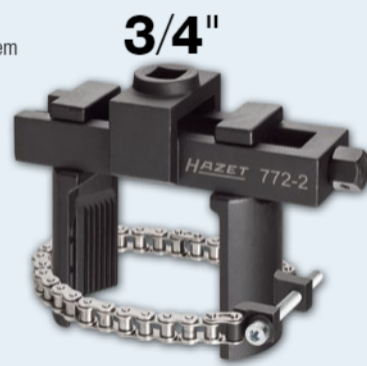

555.40 € net



4937-85 · 4937-90 · 4937-95

20 3/4 36

Commercial vehicle axle nut socket

- Solid design: high (shape) stability even with very high loosening or tightening torques
- Surface: burnished



Made in Germany

| No. | HAZET No. | Drive | Output mm | Application | EAN-No. 4000896+ | € net |
|-----|-----------|--------|-----------|--|------------------|-------|
| ① | 4937-85 | ● s 36 | s 85 | SAF trailer axles | 204267 | 253.- |
| ② | 4937-90 | ● s 36 | s 90 | IVECO Daily 6,5 t; 7,0 t | 199280 | 345.- |
| ③ | 4937-95 | 20 3/4 | s 95 | IVECO Stralis and Eurofire, MERCEDES-BENZ Discos Trailer, BPW Eco plus | 199457 | 237.- |

4937-80, EAN-No. 4000896199006

20 3/4

3/4" commercial vehicle axle nut socket, 8-point, s 80 mm

- For removal/installation of the front axle nut with 8-point in front of the brake disc
- SCANIA series R, series 4, series 124–144 I – etc.
- Suitable for impact wrenches, e.g. HAZET 9013M
- Precise fit
- Parallel surfaces for perfect force fit on axle nuts
- Solid design: high (shape) stability even with very high loosening or tightening torques



3/4"

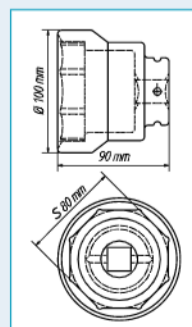

Made in Germany

210.- € net

4937-105/2, EAN-No. 4000896201938

25 1" 60 2

1" commercial vehicle axle nut socket set DAF, RENAULT, Volvo

- 6-point output: s 105 mm
- Drive: 25 mm (1") and outside 6-point s 60 mm
- Screw-in guide tube allows for flexible application
- DAF with guide tube
- RENAULT, Volvo without guide tube
- With outside guide collar



1" 60

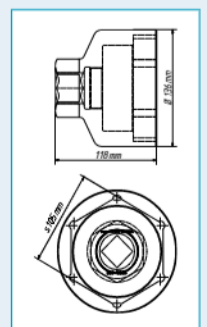

Made in Germany

444.80 € net



4937-62, EAN-No. 4000896199020 20 3/4

3/4" commercial vehicle pin wrench for rear axle MERCEDES-BENZ

- Pin wrench for rear axle nuts
- **MERCEDES-BENZ** Actros, Atego (heavy design): LN2, SK rear axle
- With outside guide collar
- Inside \varnothing : 62.8/70 mm
- 6 inside pins, pin width: 7.5 mm
- Length (total): 85 mm



3/4"

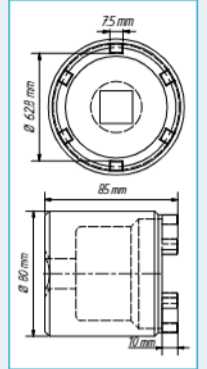

Made in Germany

280.80 € net

4937-92, EAN-No. 4000896201952 20 3/4 46

3/4" commercial vehicle pin wrench for front axle MAN

- Pin wrench for **MAN** trucks: E 2000 (ÖAF), F 2000, M 2000 L, M 2000 M
- **MAN** TGA, TGM, TGS, TGX
- **MAN** buses: Lions City, Lions Classic, Lions Coach, Lions Regio, Lions Star as well as older constructions (models), chassis
- **NEOPLAN** Cityliner, Starliner, Tourliner, Trendliner
- **TEMSA** Diamond, **WISEON** high-decker
- Diameter: 114 mm



3/4" 46

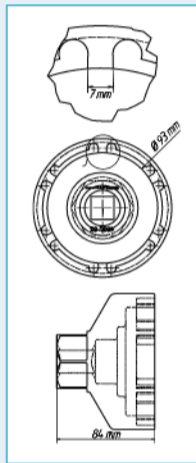

Made in Germany

260.90 € net

4937-101/4, EAN-No. 4000896199266 20 3/4 4

3/4" commercial vehicle pin wrench set for rear axle MERCEDES-BENZ

- For dismantling / assembly work on the rear axle as well as repair and maintenance work on the wheel hub, wheel bearing or brake disc
- **MERCEDES-BENZ** hub-reduction axle, such as trailing axle NR7/4
- **MERCEDES-BENZ** hub-reduction rear axles (Euro-axles) 10 t and 13 t,
- **MERCEDES-BENZ** hub-reduction axle 7 t AL7/1
- Inside \varnothing : 101.5 mm
- Length including guide tube (total): 140 mm
- 12 pins, width of pins: 11.4 mm
- With 3 replaceable guide tubes
- Outside \varnothing : 50, 51, 53 mm
- Length (total): 85 mm



3/4"

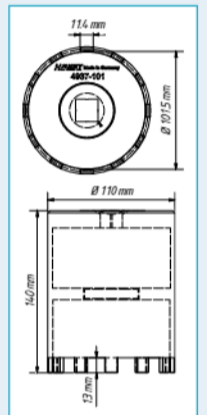

Slotted nut

Made in Germany

422.60 € net



4937-111/2, EAN-No. 4000896201945 25 1 60 2

1" commercial vehicle pin wrench set for rear axle MAN

- For **MAN** TGX, TGA, TGS e.g. rear axle: HY 1350
- 4-point drive: 25 mm (1") as well as outside 6-point: s 60 mm
- 6 pins, width: 11 mm
- Inside \varnothing : 134.5 mm
- Inside \varnothing : (pin-pin): 118 mm
- Outside \varnothing : 148.5 mm



1" 60

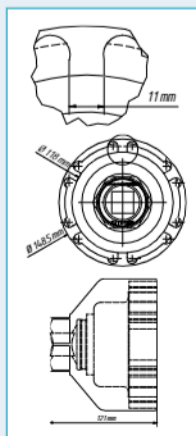

Made in Germany

507.10 € net

4937-103/3, EAN-No. 4000896199259 20 3/4 3

3/4" commercial vehicle pin wrench set for rear axle MAN and MERCEDES-BENZ

- For repair and maintenance work on the wheel hub, wheel bearing or brake disc
- For **MAN** and **MERCEDES-BENZ** 10 t and 13 t AP Hypoid and tag axle N7/4, bus 0305G, 0405G
- **MAN** hub-reduction rear axle F series H7, HD7
- Hypoid rear axle F series HY-1175, HDY-1175
- Inside \varnothing : 103 mm
- Length including guide tube (total): 140 mm
- 6 pins, width of pins: 11.5 mm
- With 2 replaceable guide tubes
- Outside \varnothing : 51.5 mm, 66.5 mm
- Length (total): 135 mm



3/4"

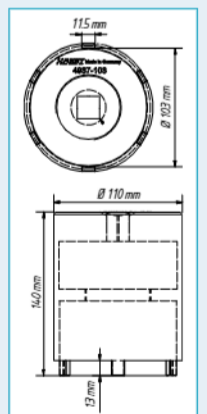

Slotted nut

Made in Germany

341.90 € net

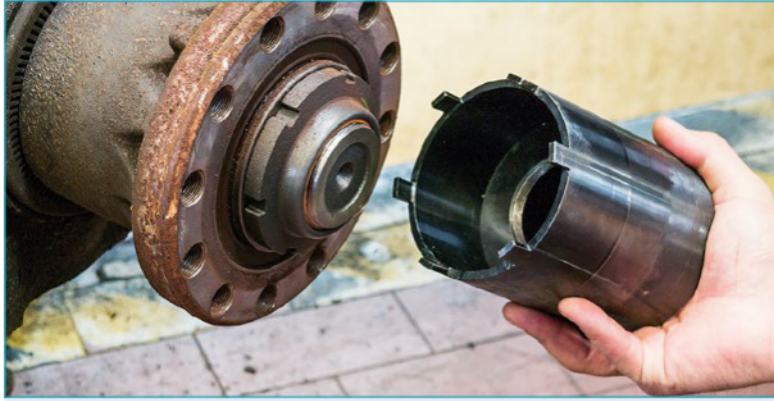

4937-87/3, EAN-No. 4000896199235

3/4" commercial vehicle pin wrench set for MAN, MERCEDES-BENZ

- For repair and maintenance work on the wheel hub, wheel bearing or brake disc
- For e.g. **MAN** TGL front axle since 2000 and L 2000 **MERCEDES-BENZ** Atego rear axle HL2, 814 Vitaro
- Pin wrench for rear axle, inside \varnothing : 87 mm
- Length (total): 65 mm
- 6 pins, width of pins: 10 mm
- With 2 replaceable guide tubes
- Outside \varnothing : 49 mm, 57 mm
- Length including guide tube (total): 140 mm

20 3/4 3

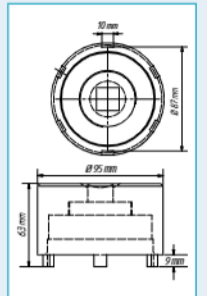

Made in Germany

341.80 € net



3/4"



4937-7588, EAN-No. 4000896202003

Commercial vehicle mounting sleeve SAF – thread M 75 x 1.5 right/left

- The bushing has both a left and a right thread, M 75 x 1.5
- For **SAF** axles with disc and drum brakes with \varnothing 88 mm bearing seat
- Only lift the 40 kg bearing unit (bearing + brake disc + wheel hub) onto the mounting bushing once, then push up to the bearing seat
- Outside \varnothing : 88 mm
- Drive via lateral rod or without additional tools is possible (handle surface)



Made in Germany

198.20 € net

4937-7578, EAN-No. 4000896201990

Commercial vehicle mounting sleeve MERCEDES-BENZ – thread M 75 x 1.5

- Mounting sleeve to protect the thread on the axle during bearing disassembly and assembly
- Use in **MERCEDES-BENZ** Atego, Atego 2, Tourino
- Only lift the approx. 40 kg bearing unit (bearing + brake disc + wheel hub) onto the mounting sleeve once, then push up to the bearing seat with \varnothing 78 mm
- Thread: M 75 x 1.5
- Outside \varnothing : 78 mm
- Drive via lateral rod or without additional tools is possible (chequered handle surface)



Made in Germany

196.- € net

4937-7582, EAN-No. 4000896201969

Commercial vehicle mounting sleeve MAN – thread M 75 x 1.5

- Mounting sleeve to protect the thread on the axle during bearing disassembly and assembly
- Use with **MAN** TGL, TGM, L series, HL 2
- Only lift the approx. 40 kg bearing unit (bearing + brake disc + wheel hub) onto the mounting sleeve once, then push up to the bearing seat with \varnothing 82 mm
- Thread: M 75 x 1.5
- Outside \varnothing : 82 mm
- Drive via lateral rod or without additional tools is possible (chequered handle surface)



Made in Germany

180.50 € net



4937-110 • 4937-120

20 3/4 25 1"

Commercial vehicle hub cap socket, \varnothing 110 mm and 120 mm for flat oval BPW hub cap

- For **BPW** Eco and Eco Plus axles
- Perfect fit for **BPW** contour \varnothing 110 mm or \varnothing 120 mm



Made in Germany

| HAZET No. | \varnothing mm | EAN-No. 4000896+ | € net |
|-----------|------------------|------------------|--------|
| 4937-110 | 110 | 199273 | 226.30 |
| 4937-120 | 120 | 210459 | 215.- |

4937-26/3 • 4937-27/3

12 1/2 3

- For fast assembly of centred truck drop centre rim wheels for rim hole \varnothing 26 mm
- No damage to the thread as well as exact centring of the rims thanks to conically cranked sleeves
- Length (total): 115 mm



Made in Germany

| HAZET No. | For rim hole \varnothing 26 mm | EAN-No. 4000896+ | € net |
|-----------|--|------------------|-------|
| 4937-26/3 | M22 x 1.5 e.g. DAF, FORD, MAN, MERCEDES-BENZ, RENAULT, Volvo | 199013 | 97.40 |
| 4937-27/3 | 3/8"-11G e.g. SCANIA | 202010 | 98.60 |

4937-100, EAN-No. 4000896201983

Commercial vehicle mounting sleeve MAN – thread M 100 x 1.5

- Mounting sleeve to protect the thread on the axle during bearing disassembly and assembly
- Use with **MAN** TGX, TGA, TGS e.g. for **MAN** HY 1350 axle (13 t)
- Only lift the approx. 40 kg bearing unit (bearing + brake disc + wheel hub) onto the mounting sleeve once, then push up to the bearing seat with \varnothing 105 mm
- Thread: M 100 x 1.5
- Outside \varnothing : 105 mm
- Drive via lateral rod or without additional tools (chequered handle surface) is possible



Made in Germany

260.70 € net

Puller

- » Universal use with many commercial vehicles
- » Safe removal of ball joint pivots and ball joints
- » Well suited for quick repair
- » Robust designs "Made in Germany"



1779-3, EAN-No. 4000896135998

Universal ball joint puller

- Universal application e.g. for trucks, lightweight design
- Jaw opening a : 32 mm
- Clamping range sb : 85 mm

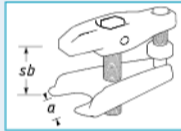

Made in Germany

180.- € net

1790-3, EAN-No. 4000896145454

Ball joint puller

- For extracting the ball joint pivots of steering arms, steering tie rods, stabilisers
- Jaw opening a : 40 mm
- Clamping range sb : 85 mm

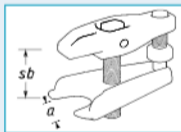

Made in Germany

223.80 € net

1779-55, EAN-No. 4000896136407

Ball joint puller

- For removing the ball joint pivots of steering tie rods, stabilizers, etc.
- Jaw opening: 55 mm
- Clamping depth: 80 mm
- Width: 77 mm



Made in Germany

169.50 € net

2784SR-1, EAN-No. 4000896229758

1/2" striking face wrench (special profile)

- Special application in case of lack of space due to design and very low vehicle body
- Optimised special profile for damage-free attachment of the flat-head lightweight nuts
- Wrench flat with laser-engraved formula for calculating the correct effective length
- For the operation of the lightweight nuts on the frame, fifth-wheel coupling, front carrier and vibration damper with special profile **MERCEDES-BENZ** on the Actros, Antos, Arocs, model year 2016 →
- Surface: phosphatized

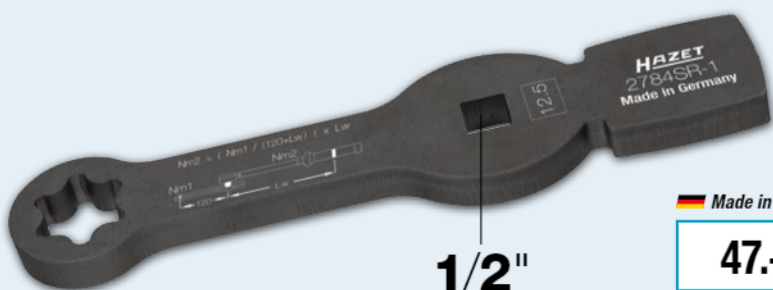

Made in Germany

1/2"

47.- € net

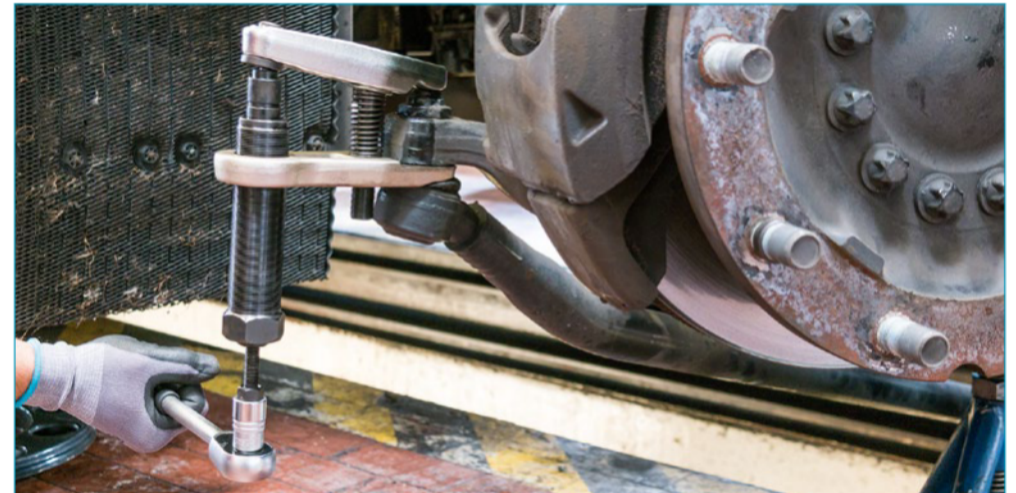

1790-5 · 1790-6

Ball joint puller

- For the easy extraction of ball joint pivots and safe removal of ball joints
- Supported by hydraulic system
- Load (max.): 12 t

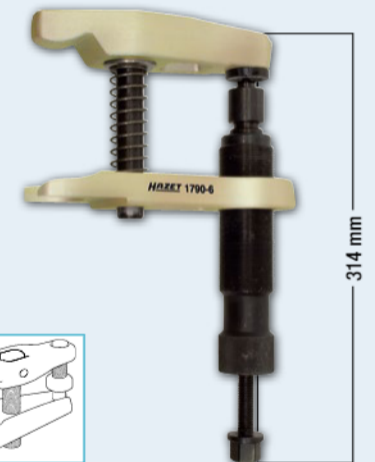

314 mm

Made in Germany

| HAZET No. | a mm | sb mm | EAN-No. 4000896+ | € net |
|-----------|-------|-------|------------------|--------|
| 1790-5 | 30-34 | 70 | 145461 | 358.30 |
| 1790-6 | 36-40 | 85 | 145478 | 530.- |

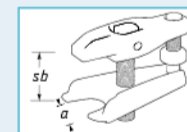

2784S-1 · 2784SLg-1

1/2" impact socket (special profile) MERCEDES-BENZ

- Optimised special profile for damage-free attachment of the flat-head lightweight nuts
- For the operation of the lightweight nuts on the frame, fifth-wheel coupling, front carrier and vibration damper with special profile **MERCEDES-BENZ** on the Actros, Antos, Arocs, model year 2016 →
- Surface: phosphatized
- Output: groove profile



1/2"



Made in Germany

| HAZET No. | Type | Length mm | EAN-No. 4000896+ | € net |
|-----------|-------|-----------|------------------|-------|
| 2784S-1 | short | 46 | 213252 | 16.- |
| 2784SLg-1 | long | 75 | 218240 | 24.20 |

720S, EAN-No. 4000896029532
Four-way rim wrench

- Forged central piece
- Length (total): 750 mm

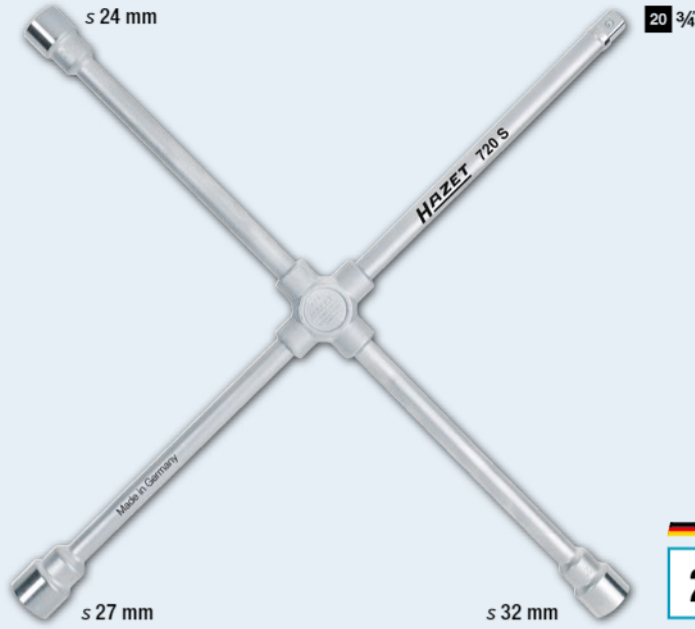

Made in Germany

221.70 € net



652 · 653
Tyre lever

- Heavy design



Made in Germany

| HAZET No. | Length mm | Weight g | EAN-No. 4000896+ | € net |
|-----------|-----------|----------|------------------|-------|
| 652 | 600 | 1,130 | 028702 | 48.30 |
| 653 | 456 | 630 | 028719 | 31.10 |



1004S · 1104S
Impact socket (6-point)

- DIN 3129, ISO 2725-1
- Wrench size: 32 mm

20 3/4" 25 1"

1004S-32

- Especially long 6-point socket design e.g. for deep wheel nuts and bolts on commercial vehicles
- For impact operation
- Surface: phosphatized



1004S-33

- Extra long pattern
- E.g. for deeply located wheel nuts and bolts on commercial vehicles
- With borehole for locking pin or safety spring and groove for o-ring



1104S-32

- For impact operation
- With bolt for locking pin retaining
- Surface: phosphatized



Made in Germany

| HAZET No. | Length mm | d ₁ mm | d ₂ mm | t mm | EAN-No. 4000896+ | € net |
|-----------|-----------|-------------------|-------------------|------|------------------|--------|
| 1004S-32 | 400 | 48.0 | 44.0 | 32.0 | 055784 | 95.30 |
| 1004S-33 | 400 | 48.0 | 44.0 | 32.0 | 055791 | 99.10 |
| 1104S-32 | 270 | 48.5 | 54.0 | 30.5 | 002665 | 106.90 |

4961N-23/12, EAN-No. 4000896186754

Wheel hub grinder

- Special grinder for optimal cleaning of the bearing surface of a wheel rim (wheel hubs) on trucks and transporters with stud bolt
- Hook and loop fastener for quick changing of grinding wheels
- Grinding wheels for moderate and heavy soiling
- With hexagon insert for firm hold at the device
- 8-point profile for safe and firm fixation
- Inside Ø (max.): 23 mm
- Grinding wheels Ø: 56 mm



For stud bolts!
 No wheel hub chippings!

Made in Germany

179.80 € net

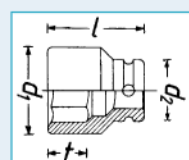

Agricultural and commercial vehicle specialty tools

- » Oil filter chain wrench and releasing tool for working in areas with restricted access
- » Radiator tester to check for leakage, e.g. in cooling systems
- » Operating tools for attachments, multi-fingers or taper key extractors
- » Problem solver for agricultural and commercial vehicles "Made in Germany"

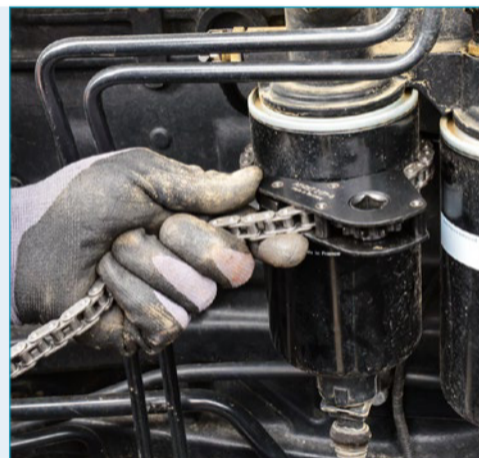

2171-8LG, EAN-No. 4000896203703

12 1/2

1/2" commercial vehicle oil filter chain wrench, open

- Clamping range 50–150 mm
- For removing oil filters and the operation of air dryer cartridges
- Especially suited to limited space
- Opening of the oil filter chain wrench facilitates application even in places which, due to the construction, cannot be reached from above with an operating tool



Open



Closed



Made in Germany

87.- €
net

2168-1, EAN-No. 4000896223251

12 1/2

1/2" commercial vehicle fuel filter wrench

- For use of fuel filter housing in construction machinery and agricultural machinery
- Easy operation with integrated square, 12.5 mm (1/2")
- For e.g.: **CLAAS** Torion, **LIEBHERR** wheel loaders and wheel loaders with Euro 6 emission standard and **LIEBHERR** engines, **JOHN DEERE** tractors series 6M, 6R · tractor series 7R · combine harvester series T · combine harvester series W · self-driving field sprayers R403, R4040L, R4050L · bulldozer 700K · Deere excavator 210G LC · harvesters 1070G, 1170G · forwarders 1110G, 1210G, 1510G · crawler forest cranes 2154G, 2154G · log loaders 2156G, 2156G LC · trailers-mounted forest cranes 337E, 437E · wheel loaders 524K, 524K-II, 524L, 544K, 544L · **Hagie** sprayers STS 10, STS 12 · **Mazzotti** MAF



1/2"

Easy loosening and unscrewing,
even in narrow work spaces!

Made in Germany

13.40 €
net

2168-2, EAN-No. 4000896226870

12 1/2

1/2" fuel filter wrench

- Can be used easily, even in areas with restricted access
- For operating the fuel filter housing when changing the fuel filter cartridge on **FORD** Duratorq 2.2 TDCI engines, Transit Custom from 04/2012 →, Tourneo Custom from 04/2012 →, Transit from 08/2013 →

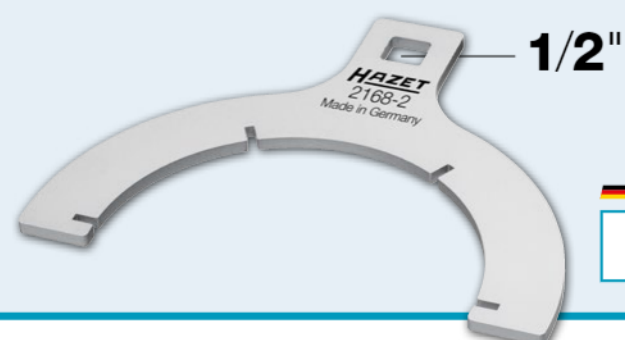

1/2"

Made in Germany

9.90 €
net



4685

Taper key extractor

- Safe removal of taper keys from gear wheels on agricultural machinery

4685-1, EAN-No. 4000896222889

Taper key extractor · Bent



Made in Germany

40.80 €
net

4685-2, EAN-No. 4000896222896

Taper key extractor · Straight



Made in Germany

40.80 €
net

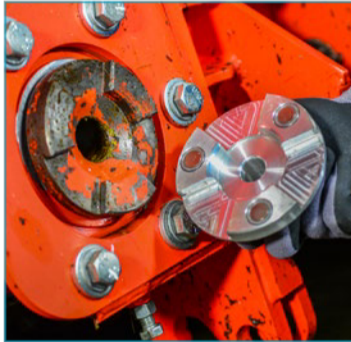

Tool with suitable profile for quick coupler

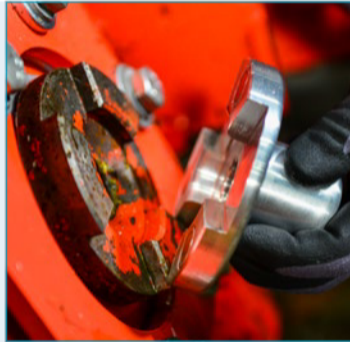

Attaching the tool

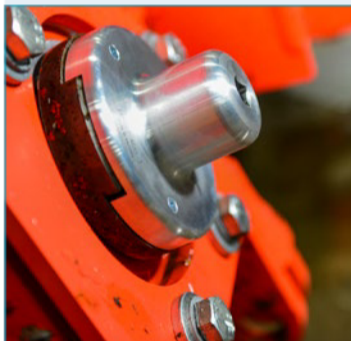

Secure hold thanks to integrated magnets

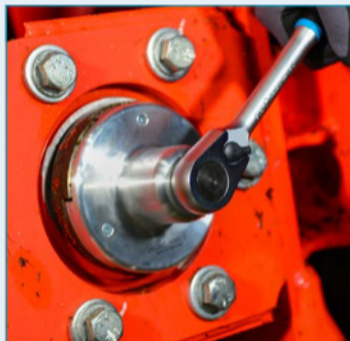

Operating using ratchet with inserted 12.5 mm (1/2") 4-point socket

4685-3, EAN-No. 4000896230730

CLAAS operating tool

- For manual operation of attachments for CLAAS JAGUAR, e.g. ORBIS, PICK UP, DIRECT DISC and CORIO CONSPEED
- 3 magnets ensure secure hold on the quick coupler
- Precise positioning of the tool on the quick coupler
- Saves on second worker by turning alone using 12.5 mm (1/2") ratchet (e.g. HAZET 916HP)
- Simple turning of the attachment possible
- Safe tool actuation outside the danger zone
- Light aluminium tool
- Especially adapted to requirements in field use

12.5 1/2

Facilitates work on the CLAAS maize header!



Made in Germany

110.70 €
net



4685-4, EAN-No. 4000896231126

12.5 1/2

Tubular socket wrench

- For dismounting/mounting the multi-fingers on CLAAS, LEXION, TUCANO and AVERO combine harvesters
- Multi-finger operation possible through the very narrow opening on the feed drum
- Easy to drive with introduced square by means of a 12.5 mm (1/2") ratchet (e.g. HAZET 916HP)
- Application of torques on multi-fingers possible
- With 6-point output: s 24 mm



Disassembly/assembly with just one tool!

Made in Germany

27.40 €
net



4800/6, EAN-No. 4000896216482

6

Radiator tester for agricultural machinery

- Checking for leakage in cooling systems and heating circuits
- 4800-1 Cooling pump to 2.5 bar
- 4800-2 Intermediary piece, flexible hose
- 4800-3 Radiator adapter for AMAZONE Pantera, CLAAS Jaguar · Lexion · Scorpion · Ares · Atlas · Ceres, FENDT, MASSEY FERGUSSON with tank no. 180224M92 and 4296015M1, CASE Quadtrac · Magnum
- 4800-4A Radiator adapter for CASE Puma · SBS · LBS · Optum · Maxxum · CVX, NEW HOLLAND TVT · T7, T7 Elite Pack · T6, FENDT Vario model year 2000 → Combine harvester L series, CLAAS Arion · Axion, DEUTZ engines 3.6 PowerPack · BF6M1013FC · TCD2013L6 2V and 4V Genset 250kV
- 4800-5A Radiator adapter for FENDT Farmer 300 model year 1988 → Type 500 · Type 700 · Vario model year 1988 → 2000
- 4800-20 Radiator adapter for CLAAS Xerion · Tucano as well as all new CLAAS machines with MERCEDES-BENZ expansion tank
- Classification to vehicles: www.hazet.de → The Tool Finder → Service → Radiator adapters 4800



Suitable for all manufacturers!

Made in Germany

338.60 €
net

2135-3000, EAN-No. 4000896231157

Sledgehammer

- Very well suited for tearing up metre-long pieces and driving aluminium wedges into wood
- Easy penetration into the wood due to specially polished cutting edge (lamella grinding technique)
- Ergonomically shaped original USA hickory wooden handle with non-slip grip end
- Impact protection sleeve to increase the service life in case of mishits (safety wedging)
- Incl. leather blade guard
- Cutting width: 75 mm
- Handle length: 900 mm
- Weight (net): 3,000 g



Stable striking face!

Made in Germany

59.- €
net

2132-1, EAN-No. 4000896244805

Aluminium felling wedge · straight

- Ideal for felling trees or ripping logs
- Conical design makes for easy cutting into wood as well as simple felling and targeted work on trees
- Forged aluminium wedge is lightweight and shatterproof
- High handling comfort thanks to light weight of only 550 g



27.- €
net

2132-2, EAN-No. 4000896244799

Aluminium splitting wedge · rotated

- The rotated, conical shape of the splitting wedge allows for easy, targeted penetration into wood and log splitting
- Especially suitable for continuous operation by professionals
- Forged aluminium wedge is lightweight and shatterproof
- High handling comfort thanks to light weight of only 800 g



38.10 €
net

2133-1250, EAN-No. 4000896231133

Wood axe

- Tool head and tool handle with triple safety wedging
- To increase service life, the handle is specially protected by an impact protection sleeve in case of failure
- Incl. silicon cutting guard
- Cutting width: 132 mm
- Handle length: 700 mm
- Weight (net): 1,250 g



Strike powerfully and divide!



Made in Germany

48.80 €
net

2134-1250, EAN-No. 4000896229529

Riving axe

- High splitting effect due to optimised head shape
- Hollow forged spreading wedges prevent the axe from jamming in the wood
- Impact protection sleeve to increase the service life in case of mishits
- Incl. leather blade guard
- Cutting width: 92 mm
- Handle length: 500 mm
- Weight (net): 1,250 g



Easier splitting thanks to spreading wedges!



Made in Germany

52.- €
net

2132-600, EAN-No. 4000896231140

Hand axe

- Handy helper, especially suitable for splitting firewood and cutting off small branches
- Tool head and tool handle with double safety wedging
- Incl. silicon cutting guard
- Cutting width: 105 mm
- Handle length: 360 mm
- Weight (net): 600 g



Versatile!



Made in Germany

30.40 €
net

2132-3, EAN-No. 4000896244607

Pickaroon

- Allows logs to be safely moved and lifted
- Ergonomically shaped handle sits comfortably in the hand
- Handle made of genuine USA hickory wood, without defects or splinters
- Use for forestry work in the woods or for working firewood
- Professional double wedging between tool head and handle
- Especially suitable for continuous operation by professionals
- Incl. rubber protective sleeve
- Handle length: 400 mm
- Weight (net): 550 g



Moving wood made easy!



26.80 €
net

4650-4, EAN-No. 4000896022038

Battery pole and terminal brush

- Cleaning the terminal posts and clamps
- With protective cover



Made in Germany
13.30 € net

4650-1, EAN-No. 4000896022014

Acid tester

- For checking the acid content of the battery fluid
- With aerometer
- Solid plastic housing – significantly reduced risk of breakage compared to glass enclosures



Made in Germany
17.20 € net



2152N/3, EAN-No. 4000896204151

Electronic set

- For troubleshooting on electronic components
- Measuring range 3–48 V
- Voltage display LED: 5, 12, 24, 48 V
- Polarity display: LED for positive or negative, AC voltage with illuminated LED
- Additional crocodile clip and probe tip for attaching
- Cable length: 1,300 mm
- Probe tip, needle with sliding mechanism



38.10 € net

4650-3, EAN-No. 4000896102051

Special tool for battery plugs

- Special length allows universal application in areas with restricted access
- For screwing battery plugs in and out
- Profile is especially suitable for battery plugs
- Plastic T-handle
- Surface: chrome-plated
- Screwdriver width: 14.5 mm
- Screwdriver height: 1.7 mm

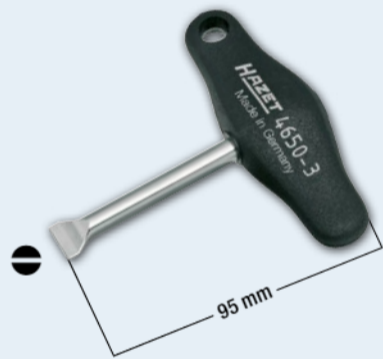

Made in Germany
12.60 € net

1862N, EAN-No. 4000896242627

Automatic wire stripper

- Automatic scanning system, no adjustment to the cable cross-section necessary
- Stripping of flexible cables (stranded wire) and solid conductors Ø 0.2–6.0 mm² or AWG 24–10
- Optimally positioned diagonal cutter up to 2.5 mm²
- Adjustable length stop: 6–15 mm
- Replaceable blades
- Not for work on or near electrically live parts

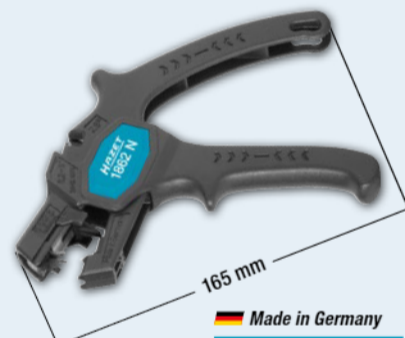

Made in Germany
20.60 € net

839-1, EAN-No. 4000896035670

Voltmeter

- 220–250 V according to standard VDE 0680
- Slotted blade, concave ground
- Extra long handle, 92 mm
- With clip
- Defective glow tube not replaceable according to VDE
- Length (total): 150 mm



Made in Germany
4.10 € net

4670-9/5, EAN-No. 4000896205042

Commercial vehicle system cable release tool assortment

- Guarantees damage-free release of the most common commercial vehicle contacts
- Malfunctions due to loose contacts can be remedied easily, quickly and professionally
- With sliding caps protecting the blades from damage and avoiding the risk of injury
- OEM quality – "Made in Germany"



For damage-free release of flat plug contacts!

Made in Germany
194.– € net

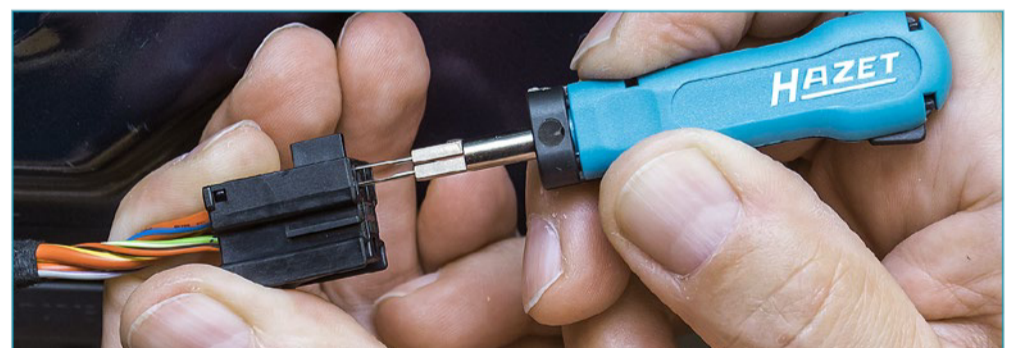

4672-11, EAN-No. 4000896135561

System cable release tool

- Installed on MERCEDES-BENZ Actros, Antos, Arocs
- For damage-free release of flat plug contacts
- Malfunctions due to loose contacts can be remedied easily, quickly and professionally
- With sliding caps protecting the blades from damage and avoiding the risk of injury
- MCP 1.5 mm/contact width 1.5 mm
- OEM quality – "Made in Germany"

For unlocking HDSCS connectors!

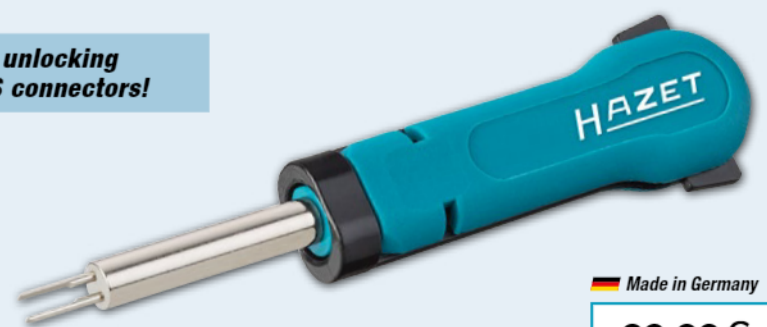

Made in Germany
39.60 € net



2152-600, EAN-No. 4000896246762

Multimeter

- For measuring voltage, resistance, frequency, capacitance and temperature
- For trade, industry, and DIYers as well as passenger car, commercial vehicle and agricultural workshops
- Easy operation thanks to clearly arranged control panel and large illuminated LCD display (all data quickly readable)
- Very short response times ensure rapid display of measurement results
- Optimal device alignment thanks to the stand on the housing
- Protective cover protects multimeter against damage from being dropped
- Temperature probe from -20 °C to 200 °C included
- Diode test
- During the continuity test, the integrated buzzer signals continuity below 50 Ω
- Duty cycle
- AC voltage/DC voltage.: 0–600 V
- DC/AC: 0–10 A
- Frequency: 0–10 MHz
- Resistance measurement: 0 to 60 MΩ
- Automatic switch-off
- Backlight
- Data hold
- True RMS
- CAT III 600V
- Including measuring tips for clipping into the protective cover and 2 x AA batteries

NEW!



118.- € net

150/39, EAN-No. 4000896239641

1/2" high-voltage tool set, with protective insulation

- Universally applicable on all trucks and buses, as well as agricultural and construction machinery with electric drives
- For operation of live components such as batteries, capacitors or distributors
- The use of two extensions enables simple and safe installation and removal of e.g. the battery thanks to the special insulation of the tools
- All the relevant tools for the operation of live fittings in one set
- Highest level of safety through constant quality control of the tools
- Delivery in new HAZET L-Boxx 136 – all tools ready to hand
- For e-trucks from e.g.: MERCEDES-BENZ, MAN, DAF, RENAULT, SCANIA and Volvo
- Suitable for use with electric urban buses such as e.g. MERCEDES-BENZ, MAN, VDL, IVECO, SOLARIS, Volvo, SCANIA, BYD, SILEO, LIKKER, COBUS, MELLOR, KARSAN, IRIZAR, EBUSCO, TEMSA, EURABUS, EASYMILE, NAVJA, LOCAL MOTORS, HEULIEZ

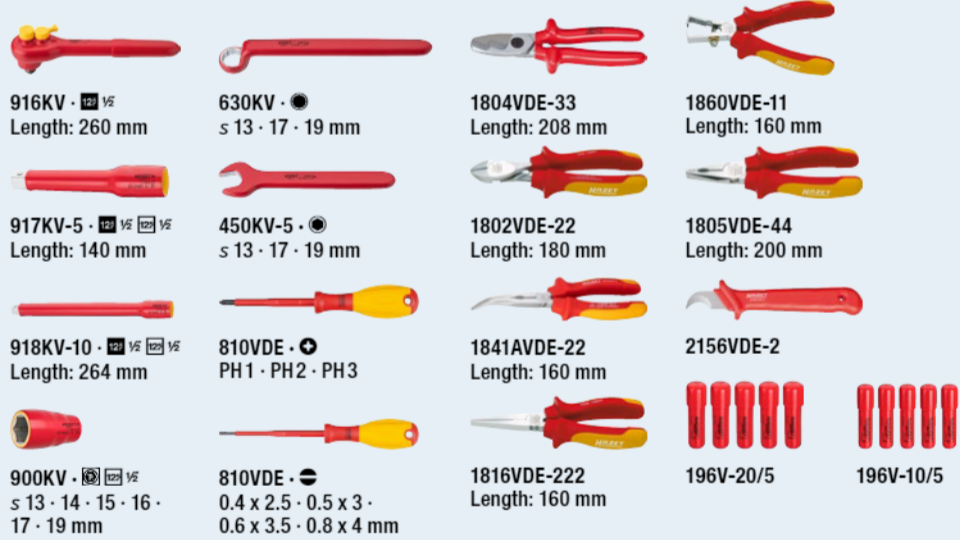

L-BOXX



L-Boxx 136

907.40 € net

5108KV · 5109KV · 5121KV

3/8" or 1/2" torque wrench, with protective insulation

- Right/left release with plug-in square, thereby tightening at torque setting both to the right and to the left within the specified tolerance
- Can be readjusted and recalibrated
- Possible repairs for the torque wrenches in the HAZET Service Centre
- High durability
- Accuracy through the option of: Disassembly, adjustment, repair (if necessary), calibration, assembly
- Suitable for control of inspection and test equipment
- Sustainable and environmentally sound
- Fine scale graduation with vernier scale
- Locking against unintentional adjustment of the setting value
- Safe torque release: palpable (close-gap release), audible ("click" sound)
- Low weight for good handling and fatigue-free work
- DIN EN ISO 6789-2:2017, Square according to DIN 3120, ISO 1174-1, IEC 60900:2018

2 – 120 Nm

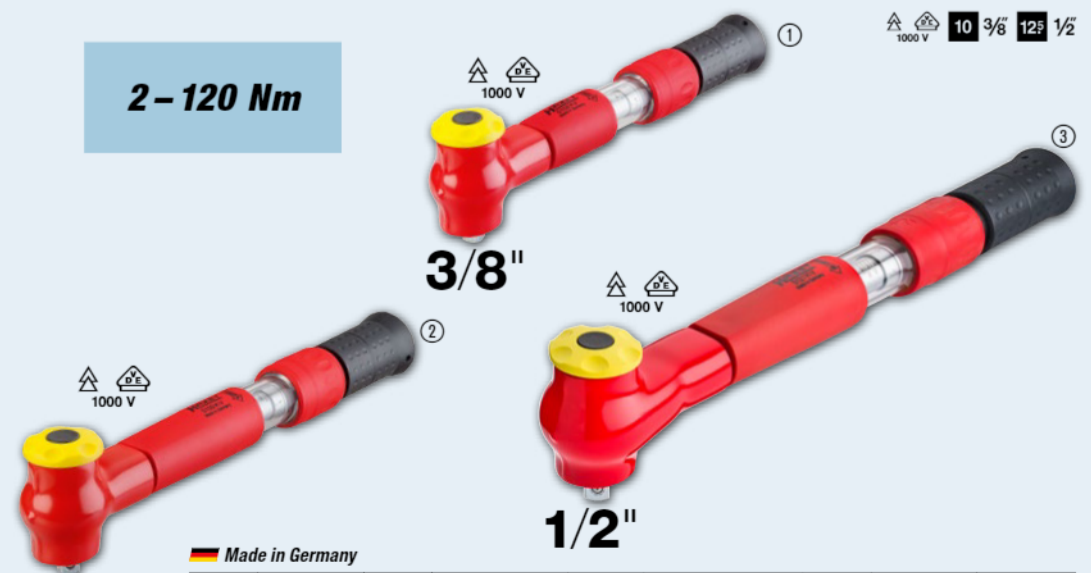

Made in Germany

| No. | HAZET No. | Torque range Nm | Length mm | Release accuracy tolerance % | b mm | EAN-No. 4000896+ | € net |
|-----|-----------|-----------------|-----------|------------------------------|------|------------------|--------|
| ① | 5108KV | 2 – 10 | 275 | 6 | 590 | 235421 | 366.90 |
| ② | 5109KV | 5 – 25 | 305 | 4 | 639 | 235445 | 378.90 |
| ③ | 5121KV | 20 – 120 | 420 | 4 | 1470 | 233397 | 385.90 |



600N/21, EAN-No. 4000896023356



Combination wrench set

- Surface: chrome-plated, head polished
- DIN 3113 form A, ISO 3318, ISO 7738
- s 6 · 7 · 8 · 9 · 10 · 11 · 12 · 13 · 14 · 15 · 16 · 17 · 18 · 19 · 21 · 22 · 24 · 27 · 30 · 32 · 34 mm
- Output: outside 12-point traction profile



Made in Germany

409.- € net

600Lg/10 · 600Lg/13

Combination wrench, extra long, slim design



Extra long style



Made in Germany

| HAZET No. | □ | S mm | EAN-No. 4000896+ | € net |
|-----------|----|--|------------------|-------|
| 600Lg/10 | 10 | 10 · 11 · 12 · 13 · 14 · 15 · 16 · 17 · 18 · 19 | 218424 | 168.- |
| 600Lg/13 | 13 | 10 · 11 · 12 · 13 · 14 · 15 · 16 · 17 · 18 · 19 · 21 · 22 · 24 | 218417 | 243.- |

606N/12, EAN-No. 4000896197378



Ratcheting combination wrench set

- Surface: chrome-plated, head polished
- DIN 3113 form A, ISO 3318, ISO 7738
- s 8 · 9 · 10 · 11 · 12 · 13 · 14 · 15 · 16 · 17 · 18 · 19 mm
- Dimensions (L x W x H): 355 x 235 x 65 mm



285.- € net

810U-1/5, EAN-No. 4000896179572



Screwdriver set

- With hex bolster (for use with a wrench) and impact cap
- Surface: blade matt chrome-plated, tip burnished
- 0.8 x 4.5 · 1 x 5.5 · 1.2 x 7 mm
- PH1 · PH2



With hex bolster (for use with a wrench)



Impact cap

37.90 € net

810T/6 · 810/6



Screwdriver set

- With hanging hole in handle
- Surface: blade matt chrome-plated, tip burnished



810T/6



810/6

| HAZET No. | Contents | EAN-No. 4000896+ | € net |
|-----------|---|------------------|-------|
| 810T/6 | ⊕ T10 · T15 · T20 · T25 · T27 · T30 | 204304 | 29.90 |
| 810/6 | ⊖ 0.5 x 3 · 0.8 x 4 · 1 x 5.5 · 1.2 x 6.5 mm ⊕ PH1 · PH2 | 058808 | 19.90 |



606/5 · 606/6-1



Ratcheting combination wrench sets



| HAZET No. | □ | S mm | EAN-No. 4000896+ | € net |
|-----------|---|-----------------------------|------------------|-------|
| 606/5 | 5 | 8 · 10 · 13 · 17 · 19 | 177998 | 99.- |
| 606/6-1 | 6 | 21 · 22 · 24 · 27 · 30 · 32 | 175178 | 435.- |

HiPer fine-tooth reversible ratchets

- » Complete range: 1/4", 3/8", 1/2"
- » 10 versions, extendable or with safety lock, among other features
- » Maximum power: almost double DIN!
(916HP 1,000 Nm, DIN 512 Nm)
- » High precision: 90 teeth
- » 4° operating angle for restricted spaces
- » Developed and produced by HAZET
"Made in Germany"



HiPer
HIGH PERFORMANCE
THE ORIGINAL
MADE IN GERMANY



HiPer (HP)
Fine-tooth reversible ratchet

- A lot more power than with ratchets of the same dimensions
- HAZET internal quality standards guarantee loading capacity far beyond the standard requirements

6.3 1/4" 6.3 1/4" 10 3/8" 12F 1/2"

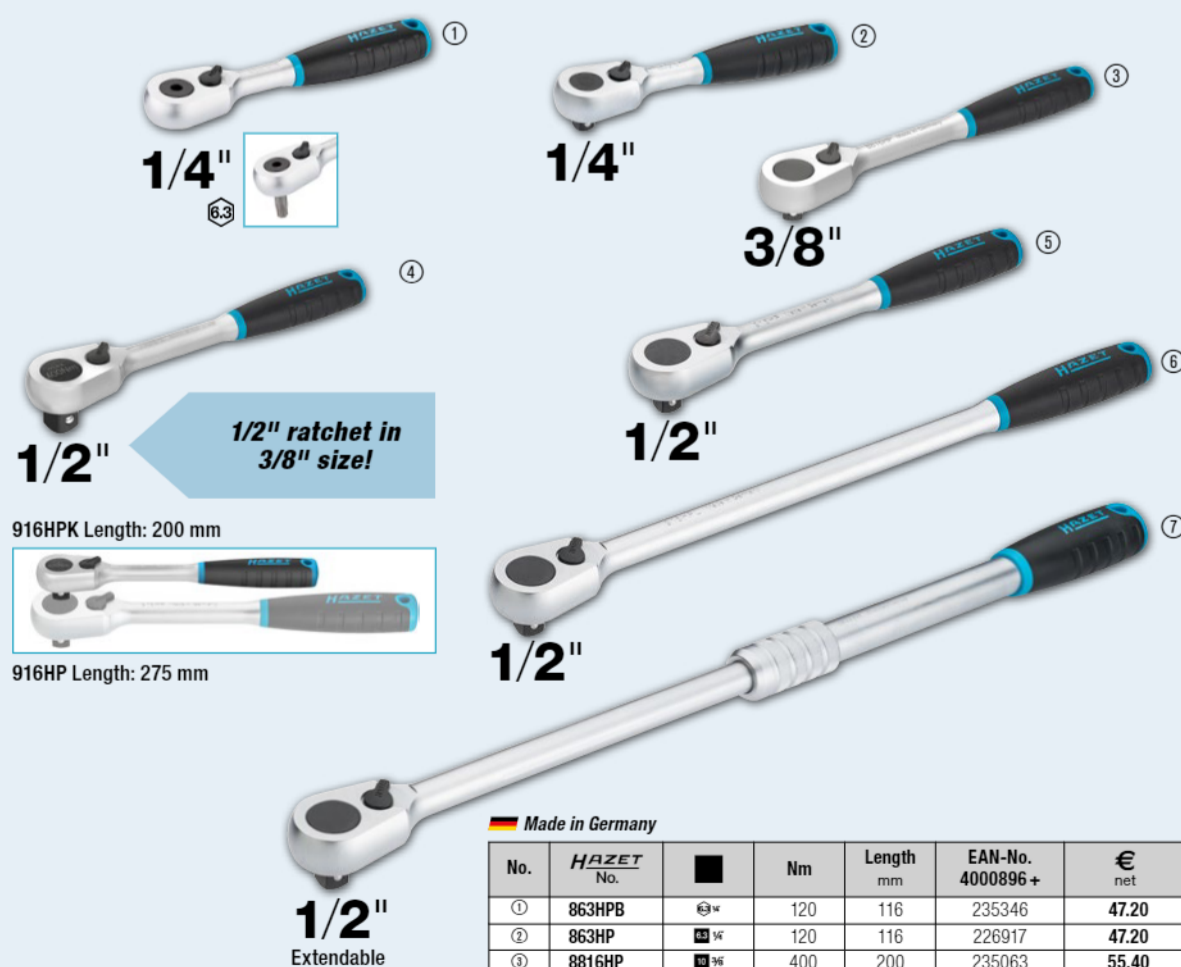

Made in Germany

| No. | HAZET No. | Nm | Length mm | EAN-No. 4000896+ | € net |
|-----|-----------|------|-----------|------------------|-------|
| ① | 863HPB | 120 | 116 | 235346 | 47.20 |
| ② | 863HP | 120 | 116 | 226917 | 47.20 |
| ③ | 8816HP | 400 | 200 | 235063 | 55.40 |
| ④ | 916HPK | 400 | 200 | 244379 | 61.70 |
| ⑤ | 916HP | 1000 | 275 | 213894 | 59.40 |
| ⑥ | 916HPL | 1000 | 415 | 219209 | 94.50 |
| ⑦ | 916HPLG | 1000 | 414-614 | 233076 | 124.- |

HiPer
HIGH PERFORMANCE
THE ORIGINAL
MADE IN GERMANY



HiPer (HPS)
Fine-tooth reversible ratchet with safety locking

- Loosening-proof locking thanks to push button actuation
- Attached tools can easily be released by pressing the button with just one hand

6.3 1/4" 10 3/8" 12F 1/2"



Made in Germany

| No. | HAZET No. | Nm | Length mm | EAN-No. 4000896+ | € net |
|-----|-----------|-----|-----------|------------------|-------|
| ① | 863HPS | 62 | 116 | 237234 | 52.20 |
| ② | 8816HPS | 340 | 200 | 237241 | 62.70 |
| ③ | 916HPS | 850 | 275 | 237258 | 72.80 |

HiPer
HIGH PERFORMANCE
THE ORIGINAL
MADE IN GERMANY



1000, EAN-No. 4000896000616

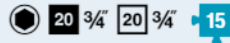

3/4" socket set

- Sheet metal box (HAZET blue)
- Soft foam insert
- Dimensions (L x W x H): 578 x 235 x 88 mm

Contents

- Reversible ratchet head 1016
- Socket 1000
- Extension 1017-8
- Extension 1018
- Handle bar 1014
- Sliding head 1015-1



Made in Germany

602.40 € net

1100Z, EAN-No. 4000896002504

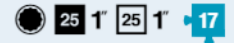

1" socket set

- With 12-point sockets
- Sheet metal box (HAZET blue)
- Dimensions (L x W x H): 759 x 305 x 115 mm

Contents

- Reversible ratchet head 1116
- Socket 1100Z
- Extension 1117-8 · 1117-16
- Handle bar 1114
- Sliding head 1115-1
- Universal joint 1121



Made in Germany

1,274.80 € net

900SK/10, EAN-No. 4000896246434

1/2" impact socket set

- Particularly suitable together with short 1/2" impact wrenches e.g. HAZET 9012ATT
- With borehole for locking pin or safety spring and groove for o-ring
- Surface: phosphatized, oiled
- DIN 3129, ISO 2725-2
- For impact operation
- Length (total): 29 mm
- s 13, 14, 15, 16, 17, 18, 19, 21, 22, 24 mm

NEW!

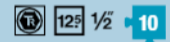

Extra short style!



In 1/9 soft foam insert



| HAZET No. | d ₁ mm | d ₂ mm | t mm |
|-----------|-------------------|-------------------|------|
| 900SK-13 | 20.8 | 25 | 7.0 |
| 900SK-14 | 22.1 | 25 | 7.0 |
| 900SK-15 | 23.5 | 30 | 7.2 |
| 900SK-16 | 24.8 | 30 | 7.2 |
| 900SK-17 | 26.2 | 30 | 7.2 |
| 900SK-18 | 27.5 | 30 | 8.7 |
| 900SK-19 | 28.8 | 30 | 11.0 |
| 900SK-21 | 31.3 | 30 | 11.5 |
| 900SK-22 | 32.5 | 30 | 12.3 |
| 900SK-24 | 35.0 | 30 | 12.2 |

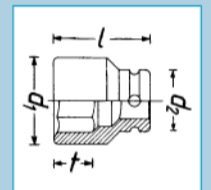

Made in Germany

107.- € net



1007S-7/4 · 1003S-07

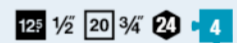

Impact adapter

- The enormous force of the 20 mm (3/4") drive results in high load on and increased wear of the 12.5 mm (1/2") output. The hexagon adaptation means the 12.5 mm (1/2") output is replaceable, making the adapter more versatile!
- With replaceable 12.5 mm (1/2") plug-in blades
- For impact operation
- With borehole for locking pin or safety spring and groove for o-ring



1003S-07



Made in Germany



| HAZET No. | Designation | EAN-No. 4000896+ | € net |
|-----------|----------------------------|------------------|-------|
| 1007S-7/4 | Impact adapter | 215416 | 40.90 |
| 1003S-07 | Replaceable plug-in blades | 215409 | 12.20 |

1000SLG · 1100SLG Impact socket (6-point)

- Long design
- With borehole for locking pin or safety spring and groove for o-ring
- Surface: phosphatized, oiled
- DIN 3129, ISO 2725-2



3/4"



1"

Made in Germany

| HAZET No. | Length mm | d ₁ mm | d ₂ mm | t mm | EAN-No. 4000896+ | € net |
|------------|-----------|-------------------|-------------------|------|------------------|-------|
| 1000SLg-24 | 100 | 39.5 | 44 | 17 | 001392 | 49.- |
| 1000SLg-27 | 100 | 43.5 | 44 | 19 | 001408 | 49.- |
| 1000SLg-30 | 100 | 47.5 | 44 | 21 | 001422 | 53.- |
| 1000SLg-32 | 100 | 50.0 | 44 | 21 | 001439 | 62.- |
| 1000SLg-33 | 100 | 51.5 | 44 | 21 | 001446 | 62.- |
| 1000SLg-36 | 100 | 55.0 | 44 | 23 | 001460 | 75.- |

Made in Germany

| HAZET No. | Length mm | d ₁ mm | d ₂ mm | t mm | EAN-No. 4000896+ | € net |
|------------|-----------|-------------------|-------------------|------|------------------|--------|
| 1100SLg-24 | 110 | 41.5 | 54 | 17 | 002405 | 77.60 |
| 1100SLg-27 | 110 | 45.0 | 54 | 19 | 002412 | 78.60 |
| 1100SLg-30 | 110 | 49.0 | 54 | 21 | 002429 | 83.20 |
| 1100SLg-32 | 110 | 51.5 | 54 | 21 | 002436 | 84.20 |
| 1100SLg-33 | 110 | 52.5 | 54 | 21 | 002443 | 88.90 |
| 1100SLg-36 | 110 | 56.5 | 54 | 23 | 002467 | 88.80 |
| 1100SLg-38 | 110 | 59.0 | 54 | 24 | 002474 | 94.40 |
| 1100SLg-41 | 110 | 63.0 | 54 | 26 | 002481 | 100.- |
| 1100SLg-46 | 110 | 69.5 | 54 | 28 | 002498 | 122.40 |

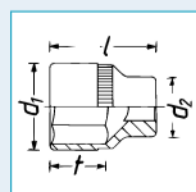

SYSTEM 5000-3CT torque wrenches – Our classic workshop tool!

- » Large measuring range: 2.5–800 Nm
- » 6 versions with 1/4", 1/2", 3/4" reversible ratchet for commercial vehicle screw connections
- » Accuracy: ±3% of scale value
- » HAZET's own service centre for best aftersales service
- » Developed and produced by HAZET "Made in Germany"



5145-3CT, EAN-No. 4000896218929
3/4" torque wrench 300–800 Nm

20 3/4"

- No more turning back!
- Release accuracy tolerance (in direction of operation): ±3% of scale value
- With serial number and certificate
- Length (total): 1,271 mm
- Graduation: 2.5 Nm

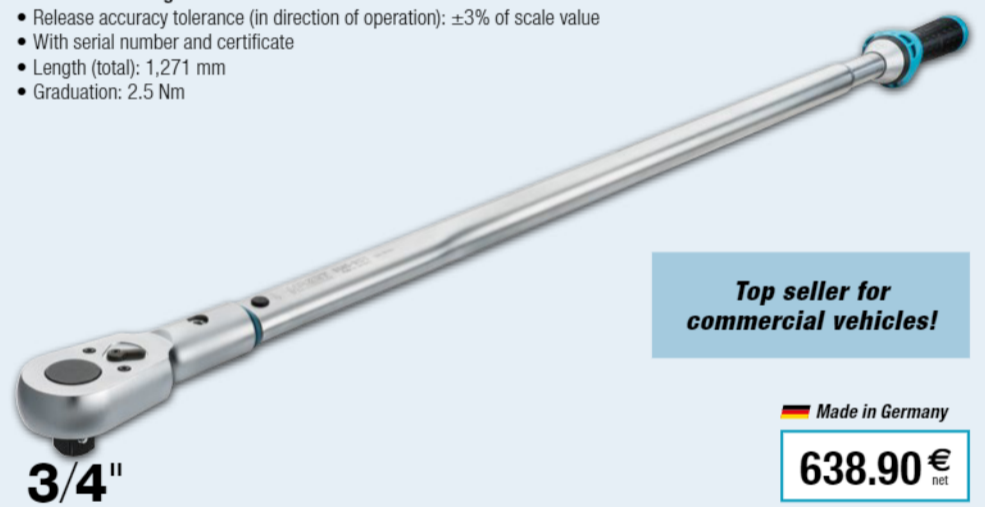

Top seller for commercial vehicles!

Made in Germany
638.90 € net

5000-3CT
1/4" or 1/2" torque wrench 2.5–400 Nm

6.3 1/4" 12.5 1/2"

- Release accuracy tolerance (in direction of operation): ±3% of scale value
- With serial number and certificate

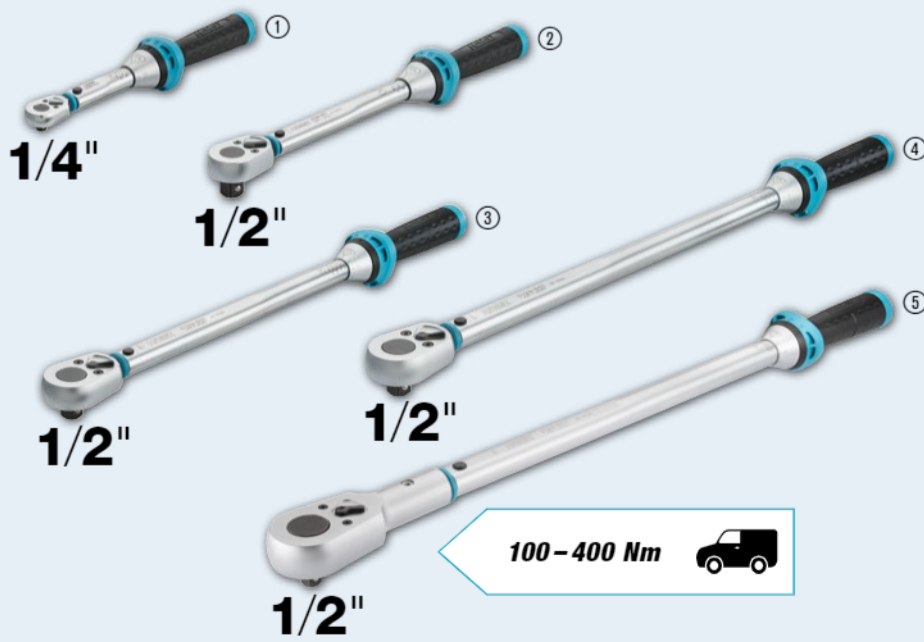

100–400 Nm 

Made in Germany



| No. | HAZET No. | □ | Torque range Nm | Length mm | Graduation Nm | EAN-No. 4000896+ | € net |
|-----|-----------|------|-----------------|-----------|---------------|------------------|--------|
| ① | 5108-3CT | 1/4" | 2.5–25 | 234 | 0.25 | 218882 | 174.90 |
| ② | 5120-3CT | 1/2" | 10–60 | 320 | 0.50 | 218905 | 160.90 |
| ③ | 5122-3CT | 1/2" | 40–200 | 519 | 1.00 | 219001 | 176.90 |
| ④ | 5123-3CT | 1/2" | 60–320 | 628 | 2.00 | 218998 | 193.90 |
| ⑤ | 5143-3CT | 3/4" | 100–400 | 790 | 2.50 | 235407 | 497.90 |

6000-1CT
3/4" or 1" torque wrench 400–1,600 Nm

20 3/4" 25 1"

- Release accuracy tolerance (in direction of operation): ±3% of scale value
- With serial number and certificate
- Incl. bag for safe storage

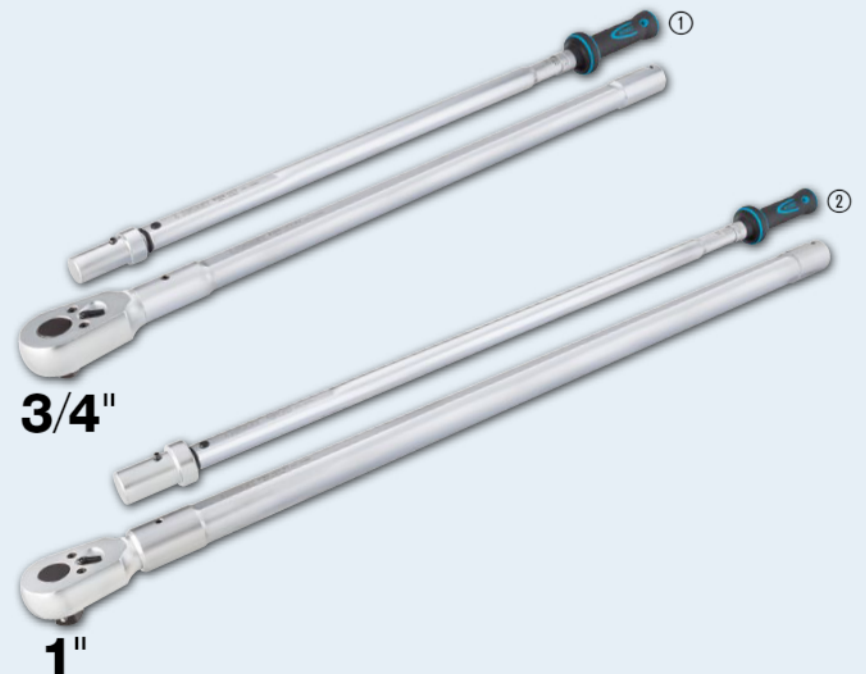

Made in Germany

| No. | HAZET No. | □ | Torque range Nm | Length mm | Graduation Nm | □ | EAN-No. 4000896+ | € net |
|-----|-----------|------|-----------------|-----------|---------------|-----------|------------------|----------|
| ① | 6150-1CT | 3/4" | 400–1,000 | 1,788 | 5 | 24.2–61.0 | 141067 | 1,210.80 |
| ② | 6160-1CT | 1" | 600–1,600 | 2,455 | 5 | 26.1–70.1 | 155316 | 1,470.90 |

Twin Turbo – The strongest HAZET impact wrench series ever!

- » 1/2", 3/4", 1" Twin Turbo impact wrenches to 4,100 Nm Power
- » Twin Effect – More power in less time!
- » Two air inlets and four air outlets
- » 8-blade air motor with 25% higher impact performance ensures maximum torque
- » Own HAZET Service Centre for best aftersales service



Twin Turbo (TT)

9012ATT, EAN-No. 4000896234738

125 1/2"

1/2" rotatable impact wrench

- Loosening torque (max.): 550 Nm*
- Operation of brake calliper screw connections and other screw-joints that are difficult to reach in the area of steering, shock absorbers, gearboxes
- Handle/trigger adjustable around its own axis for optimal handling allows operation in any position
- Innovative swivel mechanism for extended application range guarantees best accessibility
- Reduced vibrations
- One-hand operation for left- and right-handed users
- Rotation speed: 8,000 rpm
- Weight (net): 1.3 kg
- Air requirement: 113 l/min (1.9 l/sec)
- Coupler plug (incl.): 7.2 nominal size



Short, compact, angled design – only 70 mm!



160.– €
net

*Determined with screw size M16

9022SR-1, EAN-No. 4000896170593

125 1/2"

1/2" impact ratchet

- Suitable for manual retightening with torque values → 270 Nm (competitive product with approx. 250 Nm only)
- Maximum occupational safety thanks to reaction-free striking mechanism
- Low-impact
- Tightening torque (max.): 102 Nm
- Working pressure: 6.3 bar
- Length (total): 280 mm
- Weight (net): 1.28 kg
- Coupler plug (included): 7.2 nominal size



1/2"

221.– €
net

Twin Turbo (TT)

9012TT, EAN-No. 4000896226924

125 1/2"

1/2" impact wrench

- Loosening torque (max.): 2,200 Nm*
- Exhaust air is guided downwards through the handle Low vibration
- Forward/reverse: two-stage (forward), single-stage (reverse)
- Rotation speed: 8,300 rpm
- Weight (net): 1.6 kg
- Air requirement: 147.2 l/min
- Sound power level (at working pressure): 99.7 dB(A) Lp A
- Coupler plug (incl.): 7.2 nominal size



235.– €
net

*Determined with screw size M32

Twin Turbo (TT)

3/4" or 1" impact wrench

20 3/4" 25 1"

- Loosening torque (max.): 4,100 Nm*
- Exhaust air is guided downwards through the handle Low vibration
- Forward/reverse: two-stage (forward), single-stage (reverse)
- Rotation speed: 5,200 rpm
- Coupler plug (incl.): 7.2 nominal size
- Removable handle, 360° adjustable



| HAZET No. | Air requirement l/min | dB(A) | kg | EAN-No. 4000896+ | € net |
|-----------|-----------------------|-------|-----|------------------|-------|
| 9013TT | 243.5 (4.1 l/sec) | 99.5 | 4.5 | 227143 | 620.– |
| 9014TT | 235.0 (3.9 l/sec) | 101.9 | 4.6 | 234684 | 685.– |

*Determined with screw size M32

Twin Turbo (LGTT)

3/4" or 1" Twin Turbo impact wrench with long spindle

20 3/4" 25 1"

- Loosening torque (max.): 3,800 Nm (9013LGTT) - 3,850 Nm (9014LGTT)*
- Long spindle for reaching deep screw connections
- Exhaust air is guided downwards through the handle
- Long service life and high efficiency in industrial and automotive applications
- One-hand operation for left- and right-handed users
- Removable handle, 360° adjustable
- Reduced vibrations

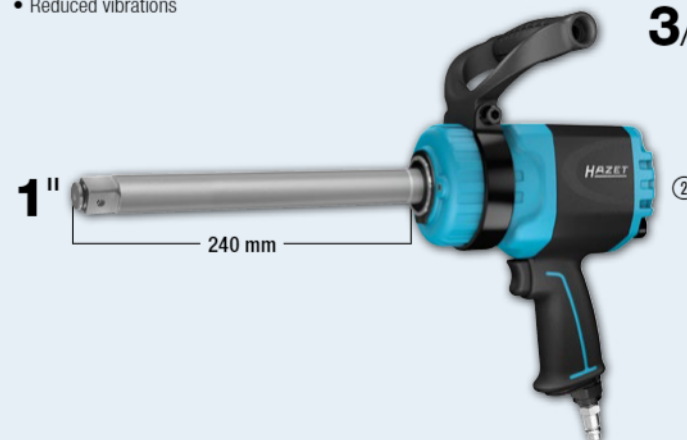

3/4"

186 mm

1"

240 mm



| No. | HAZET No. | Max. Nm | rpm | g | EAN-No. 4000896+ | € net |
|-----|-----------|---------|-------|-----|------------------|-------|
| ① | 9013LGTT | 3,800* | 5,200 | 5.5 | 232277 | 680.– |
| ② | 9014LGTT | 3,850* | 4,600 | 5.9 | 234677 | 730.– |

*Determined with screw size M32

9035-5, EAN-No. 4000896132355

Needle scaler

- Adjustable needle cover
- Removes precise, small and large emerging patches of rust
- 19 needles (Ø 3 mm)
- 3,200 impacts/min
- Air requirement: 170 l/min (2.8 l/sec)
- Length (total): 330 mm
- Weight (net): 2.6 kg
- Coupler plug (incl.): 7.2 nominal size

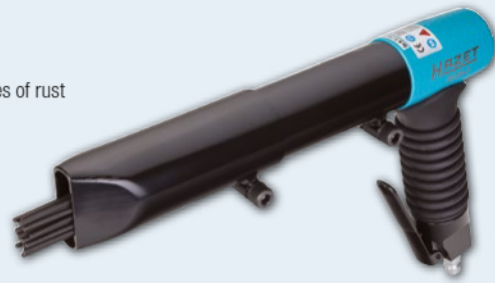

Adjustable needle cover!

296.- €
net

9032P-1, EAN-No. 4000896190508

Die grinder · straight design

- Grinding, polishing, burnishing and deburring
- Straight design, high operating comfort
- Length: 200 mm
- Hose diameter (recommended): 10 mm
- Power: 700 W
- Working pressure: 6.3 bar
- Rotation speed: 22,000 rpm
- Weight (net): 800 g
- Coupler plug (incl.): 7.2 nominal size



Extremely powerful device!

209.- €
net



9032M-36, EAN-No. 4000896209606

Mini die grinder

- Slim design for precise work with 3 mm and 6 mm grinding pads even in areas with restricted access
- Quiet operation: integrated exhaust hose removes exhaust air from the workpiece and dampens the sound
- Tool length: 150 mm
- Tool diameter: 22.2 mm
- Hose length: 1,500 mm
- Power: 224 W
- Working pressure: 6.3 bar
- Rotation speed: 30,000 rpm
- Weight (net): 380 g
- Air inlet: inside thread 12.91 mm (1/4")
- Coupler plug (incl.): 7.2 nominal size



NEW!

154.- €
net



9032MK, EAN-No. 4000896248346

Micro die grinder

- Precise processing of workpieces even in areas with very restricted access
- Long service life thanks to Kevlar blades!
- Hose length: 1,500 mm
- Power: 190 W
- Sound power level (at working pressure): 86.4 dB(A) Lp W
- Sound pressure level (at working pressure): 80.4 dB(A) Lp A
- Rotation speed: 60,000 rpm
- Weight (net): 230 g
- Air inlet: inside thread 12.91 mm (1/4")
- Coupler plug (incl.): 7.2 nominal size



NEW!

109.- €
net

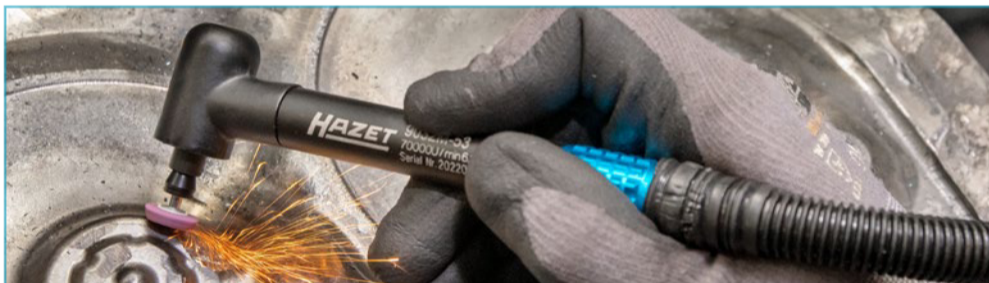

9032M-53, EAN-No. 4000896246205

Micro die grinder, angled

- Long service life thanks to high-quality Kevlar blades
- Precise processing of workpieces even in areas with very restricted access
- Tool length: 140 mm
- Tool diameter: 15.5 mm
- Power: 186.4 W
- Working pressure: 6.3 bar
- Rotation speed: 70,000 rpm
- Weight (net): 230 g
- Air inlet: inside thread 12.91 mm (1/4")
- Coupler plug (incl.): 7.2 nominal size
- Connection hose (incl.): 1,500 mm



NEW!

199.- €
net

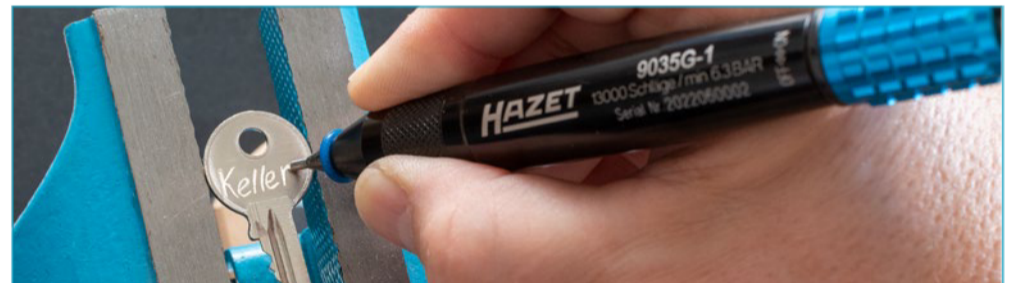

9035G-1, EAN-No. 4000896246625

Engraving pen

- Precise and lasting marking (theft protection, installation date, etc.) on workpieces (up to HRC55): metals, stone, ceramics, plastics
- Tool length: 150 mm
- Tool diameter: 22.4 mm
- Working pressure: 6.3 bar
- Rotation speed: 13,000 rpm
- Weight (net): 220 g
- Air inlet: inside thread 12.91 mm (1/4")
- Coupler plug (incl.): 7.2 nominal size
- Connection hose (incl.): 1,500 mm

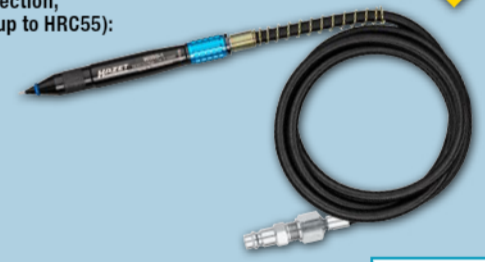

NEW!

149.- €
net

9033N-4, EAN-No. 4000896210183

Belt sander

- Continuous speed regulation via speed regulator on back of handle
- For narrow surfaces (belt width 10 mm)
- Including three abrasive belts 330 x 10 mm (grain size 80, 100, 120)
- Locking device for quick belt changing
- Automatic belt adjustment
- Including hex-head wrench for fine adjustment of the belt and angle setting in the handle
- Coupler plug (incl.): 7.2 nominal size
- Cold insulated handle
- Length (total): 291.4 mm
- Weight (net): 0.81 kg



360° rotatable belt run

182.- €
net

9033-480/10 · 9033-4100/10 · 9033-4120/10

Abrasive belt set

- Abrasive belts 330 x 10 mm
- 10 pieces per package

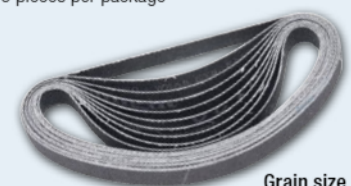

Grain size 120

| HAZET No. | Grain size | EAN-No. 4000896+ | € net |
|--------------|------------|------------------|-------|
| 9033-480/10 | 80 | 139101 | 15.- |
| 9033-4100/10 | 100 | 139118 | 15.- |
| 9033-4120/10 | 120 | 139125 | 15.- |

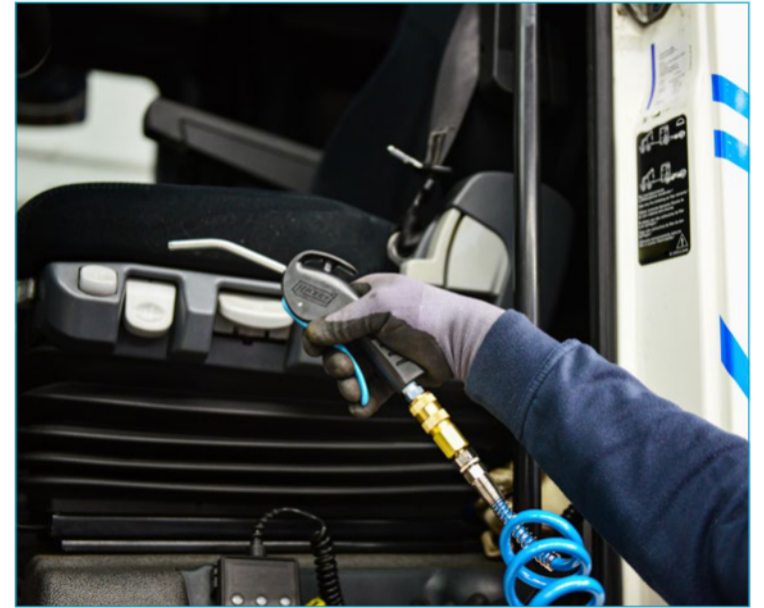

9040Lg-3/2, EAN-No. 4000896206339

Air blow gun

- With 90° lateral nozzle **1** and Venturi nozzle **2**
- For cleaning areas with restricted access on vehicles, machinery and agricultural machinery
- Especially suitable for cleaning cooling fins
- Grip area with insulated lance to protect it from cold
- Increased efficiency due to Venturi nozzle (54 mm)
- 90° lateral nozzle (32 mm) enables cleaning of cooling fins
- Pressure (max.): 12 bar
- Ergonomic handle
- Coupler plug (incl.): 7.2 nominal size
- Hose diameter (recommended): 10 mm
- Working pressure: 6.3 bar
- **Length (total): 1,085 mm**
- Air requirement: 450 l/min (7.5 l/sec)
- Weight (net): 0.31 kg

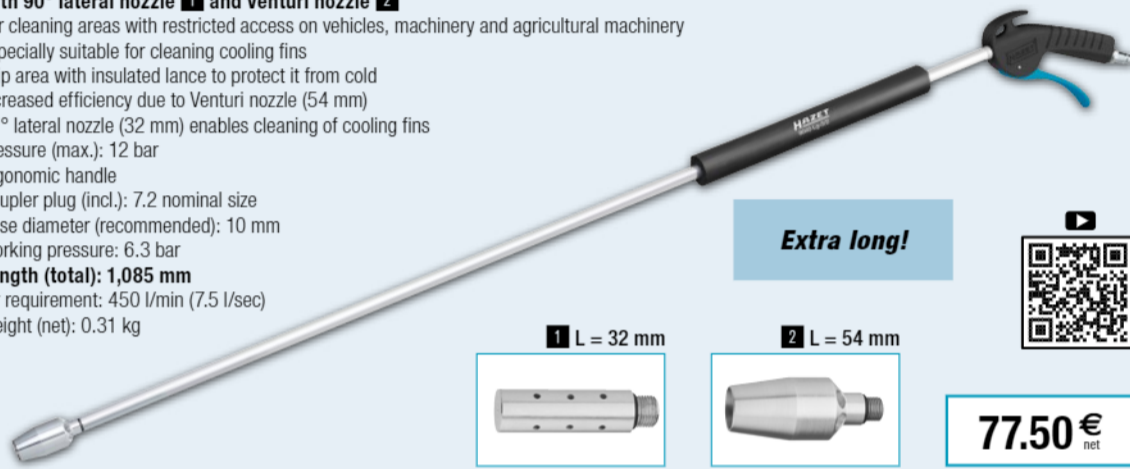

Extra long!



1 L = 32 mm

2 L = 54 mm

77.50 €
net

9040P-1, EAN-No. 4000896209545

Air blow gun 100 mm

- For fast removal of shavings or other foreign objects, especially in areas that are difficult to access
- Standard nozzle with bent pipe (∅ 8 mm)
- Coupler plug (incl.): 7.2 nominal size



15.10 €
net

9040-4, EAN-No. 4000896176236

2-way air blow gun

- Choice of air supply at tool head or handle
- Pressure regulator
- Exchangeable nozzles (steel)
- Short nozzle for areas with restricted access
- Aluminium housing
- Coupler plug (incl.): 7.2 nominal size



Including 112 mm long nozzle!

22.80 €
net

9042P-4, EAN-No. 4000896209613

Car body gun for underbody protection and cavity sealing

- Suitable for aqueous and oily liquids
- Application field: -10 °C to +80 °C
- Working pressure (max.): 16 bar
- Air requirement with cavity tube: 180 l/min at 8 bar
- Nozzles made of steel/plastic
- Coupler plug (incl.): 7.2 nominal size



Including metal intake pipe, nozzle and cavity tube!

48.50 €
net



9042N-1, EAN-No. 4000896176472

Grease gun, pneumatic

- Continuous pumping of grease
- Gun-filling with grease cartridges, loose grease or via dispenser
- **360° adjustable handle**
- Filling capacity (approx.): 400 ml
- Air requirement: 230 l/min
- Nylon tube: 230 mm
- Metal tube: 172 mm
- Weight (net): 2.0 kg
- Coupler plug (incl.): 7.2 nominal size



99.- €
net

9041-1, EAN-No. 4000896147076

Tyre inflator - standard

- Handle with operating lever and discharge knob (for one-hand use)
- Hose with plug-in nipple
- Manometer measuring range: 0–12 bar (graduation: 0.1 bar)
- Flexible tube, length: 400 mm
- Air inlet: inside thread 12.91 mm (1/4")



33.80 €
net

9041G-1, EAN-No. 4000896212385

Tyre inflator - calibrated

- Precise filling of tyres and checking the air pressure
- Calibrated device with optimally readable, large manometer
- Manometer measuring range: 0–12 bar (graduation: 0.1 bar)
- Flexible tube, length: 1,000 mm
- Air inlet: inside thread 12.91 mm (1/4")



79.90 €
net

9040-7, EAN-No. 4000896153404

Spiral hose 7.62 m

- Polyurethane
- Inside Ø: 6.35 mm
- Connecting pieces with 360° rotary joints
- Burst pressure according to DIN: 55.1 bar / 800 PSI
- Working pressure: 10 bar

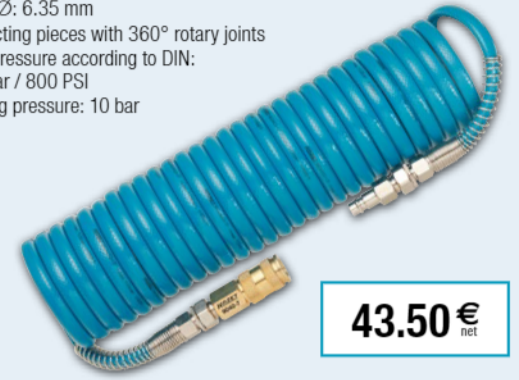

43.50 €
net



9040N-10 · 9040N-13

Hose reel

- Hose stop function possible at any point with "Stop at any point"
- Automatic guidance winds the hose neatly
- Braked winding to prevent risk of accidents
- Suitable for compressed air or water
- Black hybrid polymer hose
- Working pressure (max.): 20 bar



| HAZET No. | Hose inside Ø mm | Outside thread | °C | kg | EAN-No. 4000896 + | € net |
|-----------|------------------|----------------|--------|------|-------------------|--------|
| 9040N-10 | 10 | 16.41 mm 3/8" | -40–60 | 6.45 | 206445 | 155.90 |
| 9040N-13 | 13 | 20.96 mm 1/2" | -40–80 | 9.50 | 214648 | 184.90 |

9040D-2.5, EAN-No. 4000896214631

Cable reel

- Line stop function possible at any point with "Stop at any point"
- Braked winding to prevent risk of accidents
- Only suitable for indoor use
- Temperature range: -20 to +45 °C
- Resilient when wound up: 1,600 W
- Resilient when unwound: 3,200 W
- Weight (net): 9.2 kg



Including line circuit breaker

223.- €
net



197-3, EAN-No. 4000896158584

Magnetic cup

- Holds small parts such as screws etc.
- Magnetic foot allows fixation to tool trolleys, workshop panels, car lifts etc.
- Diameter: 150 mm



9.95 €
net



197-4, EAN-No. 4000896214235

Commercial vehicle axle oil collecting pan 3 l

- Safe collection of the oil dripping from the axle when disassembling or repairing the floating axles on trucks and agricultural machinery
- Chemical-resistant, unbreakable plastic with smooth, abrasion-proof surface
- Dimensions (L x W x H): 310 x 240 x 160 mm



19.40 €
net

4812-23/5AF, EAN-No. 4000896249824

HD touch screen, borescope set with swivelling probe 180°, Ø 3.9 mm

- Touch screen colour display with Li-Ion battery and magnetic holder
- 127 mm (5 inch) touch display, readable in sunlight
- Display resolution: 800 x 480 px
- 10-level brightness setting (5 + 5 boost)
- Zoom: 3-step
- Image format (jpg): 1,920 x 1,080 px
- Video format (MP4): 1,920 x 1,080 px
- Negative display of the camera image
- Charging time: 3.5 hrs
- Operating time when fully charged: 4 hours
- IP protection rating (basic unit): IP54
- Compatible with HAZET HD probes 4812-23AF and 4812-11FS
- Weight: 705 g
- Dimensions 4812-23G (H x B x T): 62 x 128 x 46 mm
- Dimensions 4812-23AF (H x B x T): 2,589 x 35 x 51 mm

Contents:

- Basic unit 4812-23G
- HD probe 4812-23AF
- SD card 64 GB incl. adapter
- Micro HDMI cable (D)
- USB-C cable
- HAZET L-Boxx 136

NEW!

5

Technical Specifications



1,999.- €
net

4812-11/5FS, EAN-No. 4000896249572

HD borescope set with front and side camera, Ø 4.9 mm

- Light boost and integrated reflection reduction
- Image format (jpg): 1,920 x 1,080 px
- Video format (MP4): 1,920 x 1,080 px
- Negative display of the camera image
- IP protection rating (basic unit): IP54
- USB interface can be used as a power source when no batteries are inserted
- Compatible with HAZET HD probes 4812-11FS and 4812-23AF
- Power source: 4 x AA battery
- Weight: 407 g
- Dimensions 4812-11G (H x W x D): 276 x 123 x 54 mm
- Dimensions 4812-11FS (L x W): 1,121 x 18 mm

Contents:

- Basic unit 4812-11G
- HD probe 4812-11FS
- SD card with 32 GB storage capacity
- Micro HDMI cable (A to D) 1.8 m
- USB-C cable (A to C) 1 m
- Plastic case

NEW!

5

Technical Specifications



749.- €
net

4812-23AF, EAN-No. 4000896249602

HD swivelling probe 180° Ø 3.9 mm, front camera

- Compatible with basic unit 4812-23G and 4812-11G
- Incl. control unit to operate articulation, video recording, brightness control
- High mobility due to bilateral articulation
- Full double-sided swivel up to a maximum of 180° possible
- Bending radius only approx. 35 mm (-30% compared to conventional designs)
- Resolution: HD 1,280(H) x 720(V) px
- Viewing angle (FOV): 90°
- Depth of focus (DOF): 10–100 mm
- Operating temperature: -10 °C to 60 °C
- Probe protection rating: IP67

NEW!

Technical Specifications



1,500.- €
net

4812-11FS, EAN-No. 4000896249565

HD probe Ø 4.9 mm, front and side camera

- Compatible with basic unit 4812-11G and 4812-23G
- Semi-flexible probe enables guidance through cavities
- Front and side camera switchable (0° and 90°)
- Resolution: HD 1,280(H) x 720(V) px
- Viewing angle (FOV): 90°
- Depth of focus (DOF): 10–100 mm
- Operating temperature: -10 °C to 60 °C
- Probe protection rating: IP67

NEW!

Technical Specifications



599.- €
net



1992-1, EAN-No. 4000896244270

Thermal camera

- Building diagnostics, electrical installation, sanitary, air-conditioning and heating technology as well as inspection of engine compartment, brake system, cooling and heating system
- Automatic hot, cold and central point measurement
- Screen size: 2.4" LCD screen
- Screen resolution: 320 x 240 px
- Image sensor: Vanadium oxide uncooled focal plane arrays (FPA)
- Thermal (or IR) resolution: 160 x 120 px
- Thermal sensitivity (Noise Equivalent Temperature Difference, NETD): < 40 mK (0.04 °C)
- Temperature measuring range: -20 to 550 °C (-4 °F to 1,022 °F)
- Measuring accuracy (max.): ±2 °C, ±2 %
- Protection rating: 54 IP
- Battery life: up to 8 hours (Li-Ion rechargeable battery)
- Dimensions (H x W x D): 196 x 117 x 59 mm
- Weight: 0.35 kg

Laser pointer for targeting!



Exchangeable SD card



Power supply: USB cable (Micro USB)



499.- €
net



1992-2, EAN-No. 4000896249435

Thermal camera

- Building diagnostics, electrical installation, sanitary, air-conditioning and heating technology as well as inspection of engine compartment, brake system, cooling and heating system
- Automatic hot, cold and central point measurement
- Screen size: 3.5" LCD touchscreen
- Screen resolution: 640 x 480 px
- Image sensor: Vanadium oxide uncooled focal plane arrays (FPA)
- Thermal (or IR) resolution: 256 x 192 px
- Thermal sensitivity (Noise Equivalent Temperature Difference, NETD): < 40 mK (0.04 °C)
- Temperature measuring range: -20 to 400 °C (-4 °F to 752 °F)
- Measuring accuracy (max.): ±2 °C, ±2 %
- Protection rating: 54 IP
- Battery life: up to 4 hours (Li-ion rechargeable battery)
- Dimensions (H x W x D): 138.5 x 85.2 x 23.6 mm
- Weight: 0.22 kg

NEW!

Visual camera:
3,264 x 2,448 px
(8 MP)

Digital zoom 4x

Video recording



799.- €
net



1979FC-60, EAN-No. 4000896227822

LED work spotlight 60 W

- Ideal work/building spotlight for illuminating dark building spaces
- Uniform room lighting: Energy-efficient SMD LED technology
- Rotatable dimmer switch for infinite adjustment
- Robust PU housing with surrounding aluminium components for better heat dissipation
- Visual power indication: 4-stage
- Base: 90° adjustable
- Increased functionality by 2 additional 230 V sockets on the rear which enables coupling and operation of any additional devices
- Luminous flux: 610–6,100 lumens
- Cable length: 5 m (H07RN) 3 x 1.5 mm²
- Protection rating: IP54



141.40 €_{net}



1979F-01, EAN-No. 4000896227815

Light diffuser

- Attachment for better and homogeneous room illumination and for 360° light diffusion
- Attachment can be locked using a bayonet fitting



27.40 €_{net}



1979F-02, EAN-No. 4000896227808

Magnetic holder

- Additional magnetic coating protects against damage to the substrates
- Locking mechanism using the enclosed fastening screw
- Magnetic retention force (max.): 10 kg



42.80 €_{net}

1979W-11/3, EAN-No. 4000896235247

LED pen light set, wireless charging

- **Main light COB:** 1979W-11
Luminous flux: 20–200 lm
Operating time (10–100%): 2.5–20 hrs
- **Top light SMD:** 1979W-11
Luminous flux: 120 lm
Operating time (100%): 4 hrs

Contents:

- 2 x 1979W-11 pen light
- 1979WP-2 Charging pad for 2 lights
- Incl. 100 cm USB-C cable and 2 A/5V mains plugs



Incl. charging cable + plug adapter for the charging pad

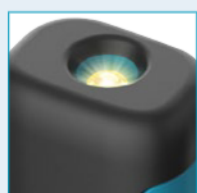

Top light 1979W-11



87.90 €_{net}

1979NW/3, EAN-No. 4000896235261

LED inspection lamp set, wireless charging

- | | | |
|---------------------------|------------|-----------|
| • Main light COB: | 1979W-11 | 1979W-82 |
| Luminous flux: | 20–200 lm | 30–300 lm |
| Operating time (10–100%): | 2.5–20 hrs | 2–10 hrs |
| • Top light SMD: | 1979W-11 | 1979W-82 |
| Luminous flux: | 120 lm | 100 lm |
| Operating time (100%): | 4 hrs | 5 hrs |

Contents:

- 1979W-11 Pen light
- 1979W-82 Pocket light
- 1979WP-2 Charging pad for 2 lights
- Incl. 100 cm USB-C cable and 2 A/5V mains plugs



Incl. charging cable + plug adapter for the charging pad



Top light 1979W-82

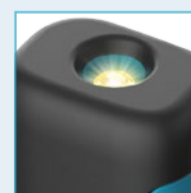

Top light 1979W-11



108.90 €_{net}

1979F-03, EAN-No. 4000896227174

Telescopic tripod

- Tripod permits a secure stand on different surfaces
- Foot locking and height locking option
- Incl. additional cable guides on tripod
- Height (max.): 185 cm
- Height (min.): 120 cm
- Load-carrying capacity: 30 kg



60.40 €_{net}

Delivery without work spotlight

1977-2/4, EAN-No. 4000896150144

Telescopic inspection mirror set

- Double hinge with tension spring

3 mirrors in one set!

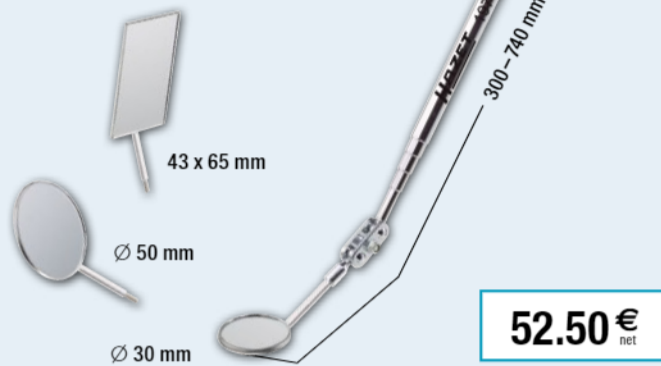

52.50 €
net

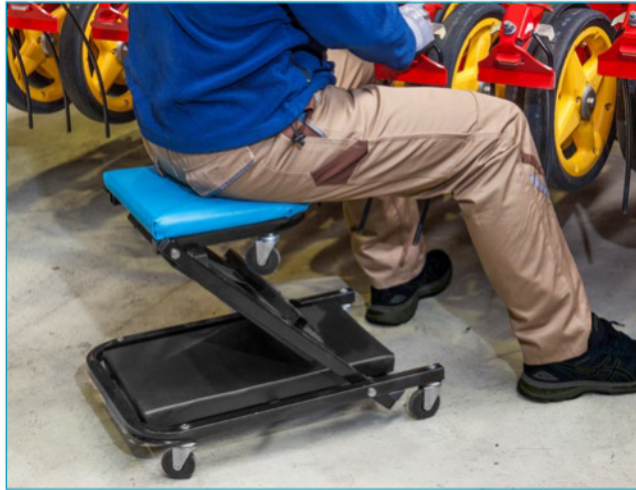

195-3, EAN-No. 4000896148691

Creeper/seat

- For convenient working on and underneath a vehicle
- Lying position (H x W x L): 130 x 450 x 1198 mm
- Seat height: 420 mm, seat base: 300 x 310 mm
- Highly resilient (up to): 150 kg
- Combines creeper and seat
- Quick and easy conversion from creeper to seat and vice versa
- Cushioned lying area, lead part coloured HAZET blue
- Sturdy steel tube frame



119.- €
net



2151, EAN-No. 4000896013043

Stethoscope

- For the localisation of damaged parts e.g. axles, bearings and gearboxes
- Diaphragm with efficient transmission rate
- Steel tip: 180 mm
- Length (total): 1,080 mm
- Weight (net): 0.13 kg



Made in Germany

79.- €
net



195-4, EAN-No. 4000896148707

Pneumatic chair

- Provides a comfortable seat at the work area
- Loading capacity (up to): 125 kg
- Tilt-resistant
- 360° rotation
- Cushioned seat base, Ø 320 mm
- 2 tool compartments
- 5 castors, Ø 60 mm



Adjustable in height from 380 to 510 mm!

99.- €
net

2157-3, EAN-No. 4000896231089

Jack-knife with blade lock

- Versatile use in the workshop
- The blade lock protects against injury when in the opened position, the knife is prevented from snapping shut unexpectedly
- Ergonomic aluminium grip thanks to moulded handle
- High-quality stainless steel blade
- Lightweight design suited for handling
- With a practical belt clip
- Length (folded): 115 mm



11.50 €
net

2150-1, EAN-No. 4000896144129

Marking tool

- For marking metal and other materials with smooth surfaces
- Special steel for long-lasting use
- With fastening clip
- Length (total): 150 mm



5.10 €
net

2151-02/2, EAN-No. 4000896062287

Ear tips

- For HAZET stethoscope 2151



Made in Germany

13.90 €
net

Tool trolleys and work benches *Assistent*

- » Series 179N – Suitable for every application: with a narrow width of 518 mm up to XXL format with a width of 1,133 mm and a depth of 642 mm
- » Extremely robust design thanks to dual-wall structure
- » Secure locking and heavy-duty drawer concept
- » Sealed working surfaces protect trolley interior
- » Developed and produced by HAZET "Made in Germany"

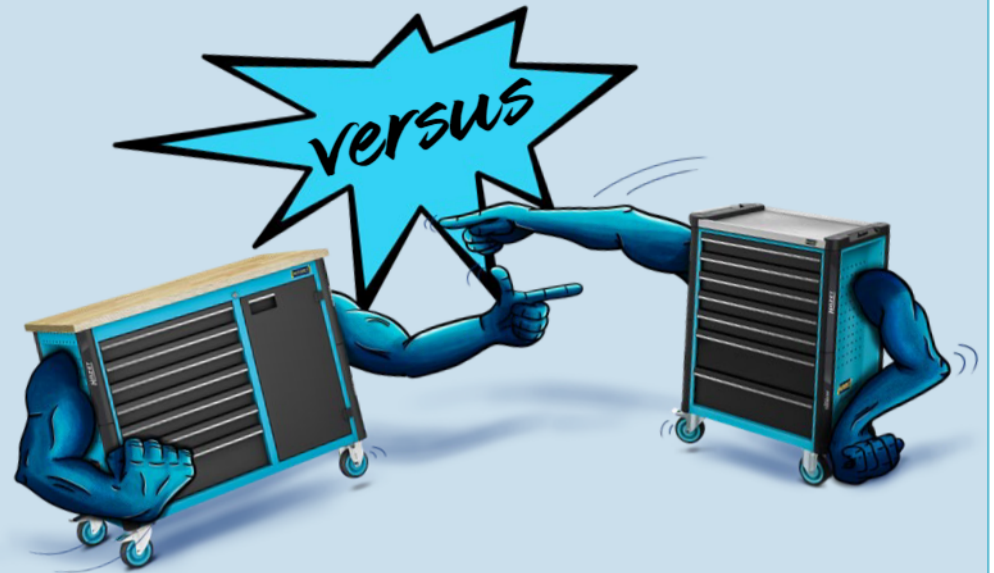

179NX-8/244,
EAN-No. 4000896223039

244

Tool trolley *Assistent* with assortment



Made in Germany

Tool trolley *Assistent* 179NX-8
Dimensions (H x W x D) 1,020 x 786 x 518 mm

| | |
|------|--|
| 3/3+ | |
|------|--|

All inclusive offer

3,650.60 €
net

179NW-8/244,
EAN-No. 4000896223046

244

Work bench *Assistent* with assortment



Made in Germany

Work bench *Assistent* 179NW-8
Dimensions (H x W x D) 964 x 1,150 x 600 mm

| | |
|------|--|
| 3/3+ | |
|------|--|

All inclusive offer

4,132.30 €
net

Incl. assortment with 244 professional tools – 7 drawers filled!

- 1 Socket/screwdriver set 163-224/57, 57 pieces
 - ⊕ ⊖ ⊕ ⊖ ⊕ ⊖ 1/4 1/4
 - ⊕ ⊖ s 5.5–13 mm ⊕ ⊖ s 10–32 mm
- 2 Socket set 163-181/17, 17 pieces
 - ⊕ ⊖ s 10–22 mm
- 3 Combination wrench set 163-210/19, 19 pieces
 - ⊕ ⊖ s 8–34 mm
- 4 Tool set 163-211/20, 20 pieces
 - ⊕ ⊖ s 8 x 9–34 x 36 mm
 - ⊕ T60, T80, T100 ⊕ s 14, 17, 19, 22 mm
- 5 Double box-end wrench set 163-296/7, 7 pieces
 - ⊕ ⊖ s 6 x 7–21 x 22 mm
- 6 Screwdriver set 163-297/26, 26 pieces
 - ⊕ ⊕ ⊕ ⊕
- 7 Ratcheting combination wrench set 163-385/12, 12 pieces
 - ⊕ ⊖ s 8–19 mm
- 8 Screwdriver socket set 163-407/35, 35 pieces
 - ⊕ ⊖ s 5–22 mm · ⊕ M5–M18 mm · ⊕ T20–T60
- 9 Pliers set 163-257/4, 4 pieces
- 10 TORX® screwdriver set 163-380/4, 4 pieces
 - ⊕ T15–T30
- 11 Socket set 163-382/3, 3 pieces
 - ⊕ s 8, 10, 13 mm
- 12 TORX® screwdriver set 163-182/9, 9 pieces
 - ⊕ T6–T30
- 13 Universal set 163-372/25, 25 pieces
- 14 Soft foam insert with compartment for small pieces 163-172 x 50
- 15 Soft foam insert with compartment for small pieces 163-522 x 50 (5 x)

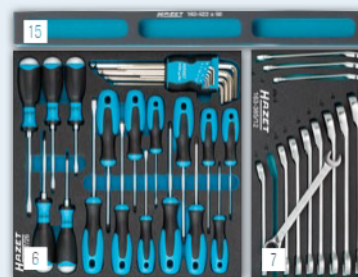
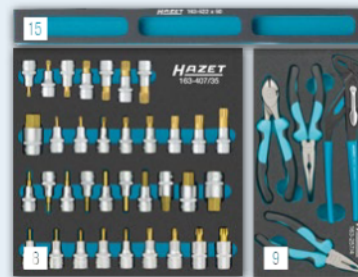
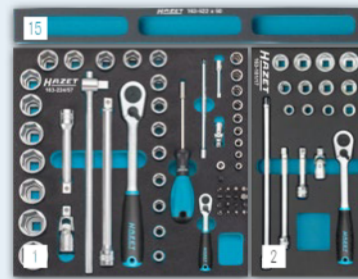

0-179/244, EAN-No. 4000896204236

**Tool assortment, individual:
244 expert tools**

| | |
|------|--|
| 3/3+ | |
|------|--|

2,566.30 €
net



179NX-8/206, EAN-No. 4000896239375

206

Tool trolley *Assistant*[®] with 206 expert tools



Screwdriver set 163-297/26
 ⚙️⚙️⚙️⚙️⚙️
 Circlip pliers set 163-531/4
 ●●



Screwdriver socket set 163-534/37
 ⚙️ 1/2" ⚙️ ⚙️ s 5–22 mm, short
 ⚙️ 1/2" ⚙️ ⚙️ s 5–10 mm, long
 ⚙️ 1/2" ⚙️ ⚙️ s 8–18 mm
 ⚙️ 1/2" ⚙️ ⚙️ T20–T60

| | |
|------|--|
| 3/3+ | |
|------|--|



Made in Germany

Tool trolley *Assistant*[®] 179NX-8
 Dimensions (H x W x D) 1,020 x 786 x 518 mm

7 drawers filled!

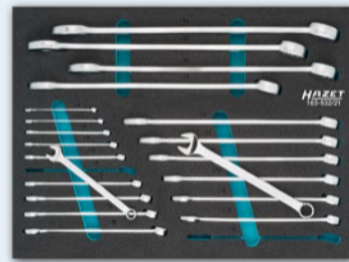

Combination wrench set 163-532/21
 ⚙️ s 6–34 mm



Tool set 163-535/18
 ⚙️ 2–8 mm
 ⚙️ 2–4 mm

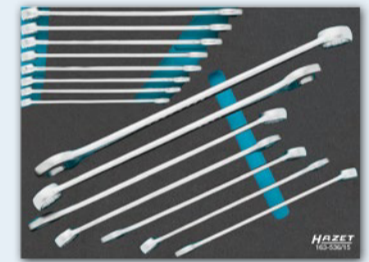

Combination wrench set 163-536/15
 ⚙️ 1/2" s 10–30 mm, long



Tool set 163-533/20
 ⚙️ s 8–24 mm
 ⚙️ s 10–60 Nm, 40–200 Nm

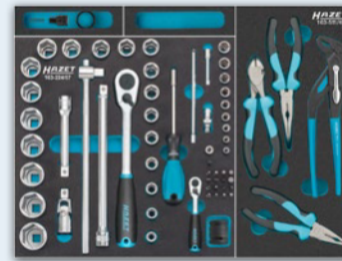

Socket set 163-224/57
 ⚙️⚙️⚙️⚙️⚙️⚙️⚙️⚙️⚙️⚙️⚙️ 1/2" 1/4" 3/8"
 Pliers set 163-511/4
HiPer



Impact adapter 1007S-7/4
 With replaceable 1/2" adapter

3,745.20 €_{net}

178N-7/147, EAN-No. 4000896205080

147

Tool trolley *Assistant*[®] with 147 expert tools



Made in Germany

Tool trolley *Assistant*[®] 178N-7
 Dimensions (H x W x D) 1,037 x 781 x 498 mm



Tool set 163-466/106
 ⚙️⚙️⚙️⚙️⚙️⚙️⚙️⚙️⚙️⚙️⚙️
 ⚙️ 1/4" s 4–13 mm ⚙️ 1/2" s 10–32 mm
HiPer



Tool set 163-330/16
 ⚙️ 810-0,5 x 3,0–1,2 x 6,5 mm, ⚙️ 810 PH1, PH2
 ⚙️ 810 T10–T30, ⚙️ 320 mm, 500 g



Combination wrench set 163-98/17
 ⚙️ 1/4" s 6–24 mm
 Double open-end wrench set 163-95/8
 s 6 x 7–21 x 22 mm

**Including HiPer
 1/4" and 1/2"
 fine-tooth reversible ratchet!**

| | |
|-----|--|
| 3/3 | |
|-----|--|

1,399.– €_{net}

Extra deep! Extra wide! Contains more!

619

179NXXL-8D/619, EAN-No. 4000896245185

Tool trolley *Assistent*[®] with 616 expert tools, lateral door and multiple socket strip

H x W x D: 1,020 x 1,133 x 642 mm

- More drawer space for tools due to greater drawer depth!
- Much larger storage and work areas made from stainless steel!
- 7 flat drawers (81 x 870 x 522 mm) and one high drawer (166 x 870 x 522 mm)
- 100% drawer slide-out with ball-bearing telescopic slides
- Loading capacity per drawer: 40 kg

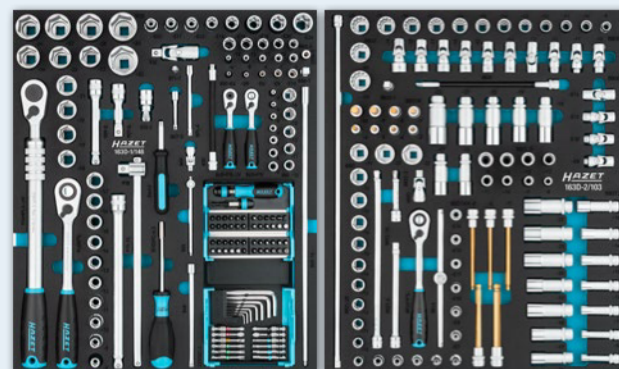

163D-1/148

1/8 1/4 3/8 1/2 5/8 3/4 7/8 1 1 1/4 1 1/2 1 3/4 2 2 1/4 2 1/2 3 4

163D-2/103

1/8 1/4 3/8 1/2 5/8 3/4 7/8 1 1 1/4 1 1/2 1 3/4 2 2 1/4 2 1/2 3 4

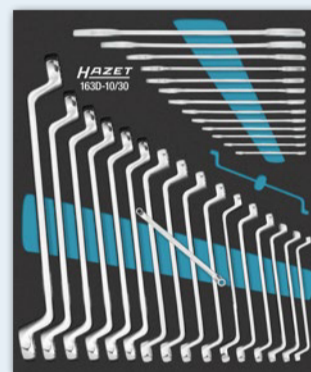

163D-10/30

s 5 x 5,5 – 34 x 36 mm
s 6 x 7 – 36 x 41 mm



163D-9/42

s 8 – 32 mm
s 5,5 – 32 mm

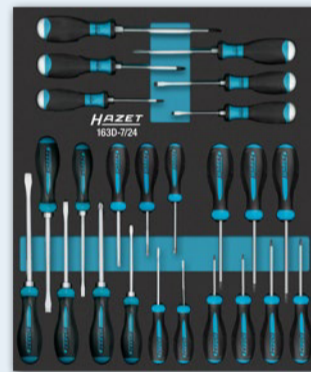

163D-7/24

20 25 32 40 50 63 80 100



163D-6/53

20 25 32 40 50 63 80 100

1/2++ 1/2++



163D-5/24

20 25 32 40 50 63 80 100



163D-12/30



163D-11/11

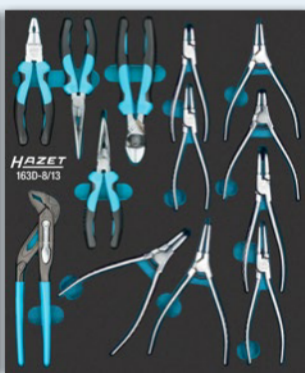

163D-8/13

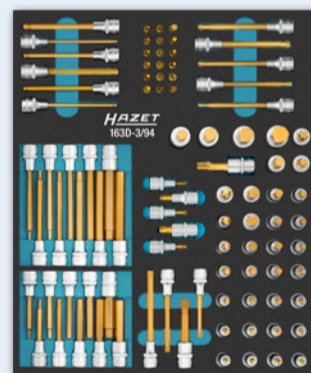

163D-3/94

1/8 1/4 3/8 1/2 5/8 3/4 7/8 1 1 1/4 1 1/2 1 3/4 2 2 1/4 2 1/2 3 4

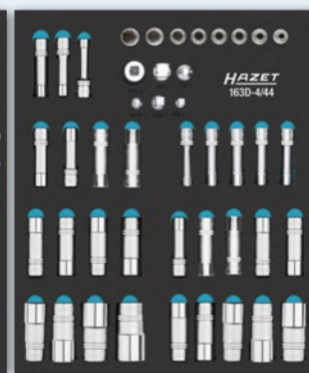

163D-4/44

1/8 1/4 3/8 1/2 5/8 3/4 7/8 1 1 1/4 1 1/2 1 3/4 2 2 1/4 2 1/2 3 4

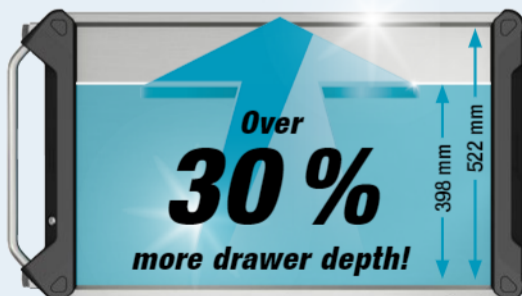

Drawer depth comparison: 179NXXL-8D (522 mm) with 179N series (398 mm)

Your HAZET specialist dealer



NKW23/EN/XX/1/I. 02.23/5 CHS/MD



Made in Germany
Tool trolley *Assistent*[®]
179NXXL-8D

Incl. lateral door HAZET 179N-21D and multiple socket strip HAZET 161N-5D

8,585.– € net